



## Anchoring

For all order enquiries  
call **07 3801 8885**

[temsupplies.com.au](http://temsupplies.com.au)



# ANCHORING



## friulsider ATS-evo

ATS-evo S - Hex head bolt Carbon Steel Class 8.8 Zinc Clear

ATS-evo B - Threaded bar Carbon Steel Class 8.8 Zinc Clear



Made in Italy

ZINC INTERNAL

ZINC INTERNAL



| Part No.                     | Part No.                     | Description           | mm | Clearance /mm | mm  | Thread / mm | Socket / mm | qty |
|------------------------------|------------------------------|-----------------------|----|---------------|-----|-------------|-------------|-----|
| ATSeS10070<br>(79302b10070)  | ATSeB10070*<br>(79402b10070) | 10 x 70mm (M6 Bolt)   | 10 | 12            | 10  | 70          | 10          | 50  |
| ATSeS10080<br>(79302b10080)  | ATSeB10080*<br>(79402b10080) | 10 x 80mm (M6 Bolt)   |    |               | 20  | 80          |             | 50  |
| ATSeS10110<br>(79302b10110)  | ATSeB10110*<br>(79402b10110) | 10 x 110mm (M6 Bolt)  |    |               | 50  | 110         |             | 50  |
| ATSeS12080<br>(79302b12080)  | ATSeB12080*<br>(79402b12080) | 12 x 80mm (M8 Bolt)   | 12 | 14            | 10  | 80          | 13          | 25  |
| ATSeS12090<br>(79302b12090)  | ATSeB12090*<br>(79402b12090) | 12 x 90mm (M8 Bolt)   |    |               | 20  | 90          |             | 25  |
| ATSeS12120<br>(79302b12120)  | ATSeB12120*<br>(79402b12120) | 12 x 120mm (M8 Bolt)  |    |               | 50  | 120         |             | 25  |
| ATSeS15090<br>(79302b15090)  | ATSeB15090*<br>(79402b15090) | 15 x 90mm (M10 Bolt)  | 15 | 17            | 10  | 90          | 17          | 20  |
| ATSeS15100<br>(79302b15100)  | ATSeB15100*<br>(79402b15100) | 15 x 100mm (M10 Bolt) |    |               | 20  | 100         |             | 20  |
| ATSeS15130<br>(79302b15130)  | ATSeB15130*<br>(79402b15130) | 15 x 130mm (M10 Bolt) |    |               | 50  | 130         |             | 20  |
| ATSeS15180<br>(79302b15180)  | ATSeB15180*<br>(79402b15180) | 15 x 180mm (M10 Bolt) |    |               | 100 | 180         |             | 20  |
| ATSeS18110<br>(79302b18110)  | ATSeB18110*<br>(79402b18110) | 18 x 110mm (M12 Bolt) | 18 | 20            | 10  | 110         | 19          | 20  |
| ATSeS18125<br>(79302b18125)  | ATSeB18125*<br>(79402b18125) | 18 x 125mm (M12 Bolt) |    |               | 25  | 125         |             | 20  |
| ATSeS18150<br>(79302b18150)  | ATSeB18150*<br>(79402b18150) | 18 x 150mm (M12 Bolt) |    |               | 50  | 150         |             | 20  |
| ATSeS18200<br>(79302b18200)  | ATSeB18200*<br>(79402b18200) | 18 x 200mm (M12 Bolt) |    |               | 100 | 200         |             | 20  |
| ATSeS24125<br>(79302b24125)  | ATSeB24125*<br>(79402b24125) | 24 x 125mm (M16 Bolt) | 24 | 26            | 10  | 125         | 24          | 10  |
| ATSeS24140<br>(79302b24140)  | ATSeB24140*<br>(79402b24140) | 24 x 140mm (M16 Bolt) |    |               | 25  | 140         |             | 10  |
| ATSeS24165<br>(79302b24165)  | ATSeB24165*<br>(79402b24165) | 24 x 165mm (M16 Bolt) |    |               | 50  | 165         |             | 10  |
| ATSeS24215<br>(79302b24215)  | ATSeB24215*<br>(79402b24215) | 24 x 215mm (M16 Bolt) |    |               | 100 | 215         |             | 10  |
| ATSeS28160*<br>(79302b28160) | ATSeB28160*<br>(79402b28160) | 28 x 160mm (M20 Bolt) | 28 | 31            | 10  | 160         | 30          | 4   |
| ATSeS28180<br>(79302b28180)  | ATSeB28180*<br>(79402b28180) | 28 x 180mm (M20 Bolt) |    |               | 30  | 180         |             | 4   |
| ATSeS28210<br>(79302b28210)  | ATSeB28210*<br>(79402b28210) | 28 x 210mm (M20 Bolt) |    |               | 60  | 210         |             | 4   |
| ATSeS28250*<br>(79302b28250) | ATSeB28250*<br>(79402b28250) | 28 x 250mm (M20 Bolt) |    |               | 100 | 250         |             | 4   |
| ATSeS32180<br>(79302b32180)  | ATSeB32180*<br>(79402b32180) | 32 x 180mm (M24 Bolt) | 32 | 35            | 10  | 180         | 36          | 4   |
| ATSeS32200<br>(79302b32200)  | ATSeB32200*<br>(79402b32200) | 32 x 200mm (M24 Bolt) |    |               | 30  | 200         |             | 4   |
| ATSeS32230<br>(79302b32230)  | ATSeB32230*<br>(79402b32230) | 32 x 230mm (M24 Bolt) |    |               | 60  | 230         |             | 4   |

\* Contact ICCONS for availability - lead times may apply



# friulsider ATS-evo

ATS-evo SK - Countersunk bolt hex socket Carbon Steel Class 8.8 Zinc Clear



Made in Italy



ZINC INTERNAL



| Part No.                            | Description           | mm | Clearance /mm | mm | mm  | mm | mm | mm | qty |
|-------------------------------------|-----------------------|----|---------------|----|-----|----|----|----|-----|
| <b>ATSeSK10070</b><br>(79303b10070) | 10 x 70mm (M6 Bolt)   | 10 | 12            | 15 | 70  | 17 | 5  | 50 |     |
| <b>ATSeSK10080</b><br>(79303b10080) | 10 x 80mm (M6 Bolt)   |    |               | 25 | 80  |    |    | 50 |     |
| <b>ATSeSK12080</b><br>(79303b12080) | 12 x 80mm (M8 Bolt)   | 12 | 14            | 16 | 80  | 21 | 6  | 25 |     |
| <b>ATSeSK12090</b><br>(79303b12090) | 12 x 90mm (M8 Bolt)   |    |               | 26 | 90  |    |    | 25 |     |
| <b>ATSeSK15090</b><br>(79303b15090) | 15 x 90mm (M10 Bolt)  | 15 | 17            | 17 | 90  | 26 | 7  | 20 |     |
| <b>ATSeSK15100</b><br>(79303b15100) | 15 x 100mm (M10 Bolt) |    |               | 27 | 100 |    |    | 20 |     |
| <b>ATSeSK18125</b><br>(79303b18125) | 18 x 125mm (M12 Bolt) | 18 | 20            | 33 | 125 | 31 | 8  | 20 |     |





**ANCHORING**

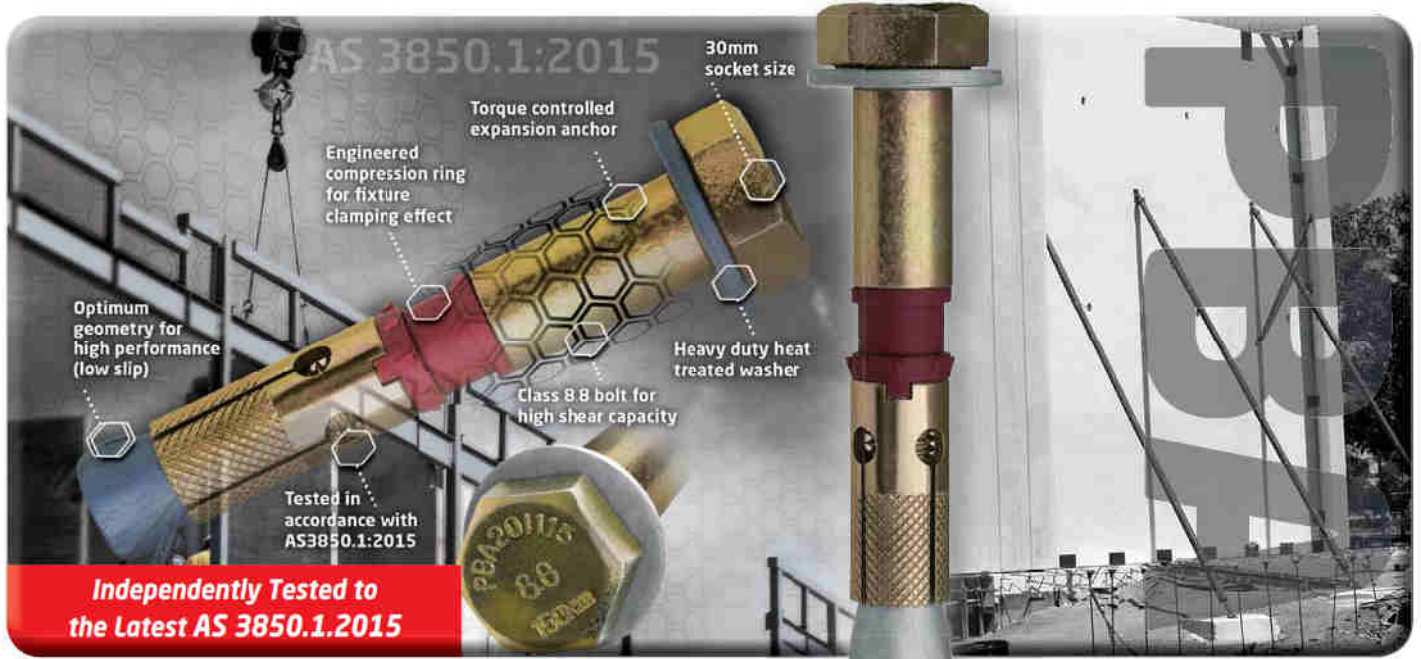

## PBA - Heavy Duty Panel Brace Anchor

■ PBA Carbon Steel Class 8.8 Zinc Yellow



ZINC

INTERNAL / TEMPORARY EXTERNAL



| Part No. | Description | mm | mm | mm | mm | Nm  | qty | qty |
|----------|-------------|----|----|----|----|-----|-----|-----|
| PBA20115 | M14 x 115mm | 20 | 95 | 30 | 20 | 150 | 25  | 75  |

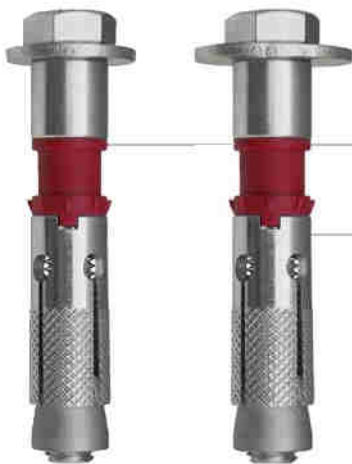

## STA - Heavy Duty Structural Anchor

Standard Washer - STA Carbon Steel Class 8.8 Zinc Clear

Large Washer - STA Carbon Steel Class 8.8 Zinc Clear

High performing heavy duty torque controlled expansion anchor, Consists of an 8.8 bolt, heavy duty thick expansion sleeve, heavy duty washer, Hardened cone and a nylon compression ring. Suitable for applications such structural connections, beam supports, columns and heavy machinery etc.

ZINC

INTERNAL

ZINC

INTERNAL



| Part No. | Description | mm          | mm  | mm | mm | Nm  | qty | qty |    |
|----------|-------------|-------------|-----|----|----|-----|-----|-----|----|
| STA15110 | M10 x 110mm | 15          | 90  | 17 | 20 | 50  | 25  | 75  |    |
| STA18090 | STA18090LW  | M12 x 90mm  | 18  | 75 | 19 | 15  | 80  | 25  | 75 |
| STA18130 | M12 x 130mm |             | 105 |    | 25 |     | 25  | 75  |    |
| STA20110 | STA20110LW  | M14 x 110mm | 20  | 85 | 22 | 25  | 150 | 10  | 40 |
| STA24130 | M16 x 130mm | 24          | 100 | 24 | 30 | 180 | 10  | 40  |    |
| STA24145 | M16 x 145mm |             | 115 |    | 30 |     | 10  | 40  |    |



# Maximum performance, with seismic certification C2.

**SOLID EXPANSION**  
Stainless steel clip  
with proprietary design



**GREATER STABILITY**  
Nine gripping dents  
for undercutting  
action into concrete



## NAUTILUS

**1000 h**

Special anti-corrosion coating  
1000 hours in salt spray test



### APPLICATIONS:

Steel/Aluminium constructions which require a high certified level of safety

- Suspended applications
- Data centres & high risk applications
- Heavy duty machinery
- Airports & transport infrastructure
- Structural applications in seismic areas
- Bridging & tunnelling
- Public infrastructure







## ANCHORING



# friulsider FM753<sup>®</sup> CRACK

■ Carbon Steel Class 9.8 Nautilus - Galvanised

■ Stainless Steel 316 INOX A4



Made in Italy

GAL

EXTERNAL

316 SS

EXTERNAL



| Part No.                             | Part No.                              | Description | mm | Clearance /mm | mm  | Thread / mm | Socket / mm | qty | qty |
|--------------------------------------|---------------------------------------|-------------|----|---------------|-----|-------------|-------------|-----|-----|
| <b>FM753C08068G</b><br>(75350b08068) | <b>FM753C08068SS</b><br>(75350008068) | M8 x 68mm   | 8  | 9             | 4   | 30          | 13          | 100 | 400 |
| <b>FM753C08075G</b><br>(75350b08075) | <b>FM753C08075SS</b><br>(75350008075) | M8 x 75mm   |    | 9             | 10  | 30          | 13          | 100 | 400 |
| <b>FM753C08090G</b><br>(75350b08090) | <b>FM753C08090SS</b><br>(75350008090) | M8 x 90mm   |    | 9             | 25  | 40          | 13          | 100 | 400 |
| <b>FM753C08115G</b><br>(75350b08115) | <b>FM753C08115SS</b><br>(75350008115) | M8 x 115mm  |    | 9             | 50  | 60          | 13          | 100 | 400 |
| <b>FM753C08135G</b><br>(75350b08135) | <b>FM753C08135SS</b><br>(75350008135) | M8 x 135mm  |    | 9             | 70  | 80          | 13          | 100 | 400 |
| <b>FM753C08165G</b><br>(75350b08165) | <b>FM753C08165SS</b><br>(75350008165) | M8 x 165mm  |    | 9             | 100 | 80          | 13          | 50  | 200 |
| <b>FM753C10090G</b><br>(75350b10090) | <b>FM753C10090SS</b><br>(75350010090) | M10 x 90mm  | 10 | 12            | 10  | 40          | 17          | 50  | 200 |
| <b>FM753C10105G</b><br>(75350b10105) | <b>FM753C10105SS</b><br>(75350010105) | M10 x 105mm |    | 12            | 25  | 55          | 17          | 50  | 200 |
| <b>FM753C10115G</b><br>(75350b10115) | <b>FM753C10115SS</b><br>(75350010115) | M10 x 115mm |    | 12            | 35  | 55          | 17          | 50  | 200 |
| <b>FM753C10135G</b><br>(75350b10135) | <b>FM753C10135SS</b><br>(75350010135) | M10 x 135mm |    | 12            | 55  | 85          | 17          | 50  | 200 |
| <b>FM753C10155G</b><br>(75350b10155) | <b>FM753C10155SS</b><br>(75350010155) | M10 x 155mm |    | 12            | 75  | 85          | 17          | 50  | 200 |
| <b>FM753C10185G</b><br>(75350b10185) | <b>FM753C10185SS</b><br>(75350010185) | M10 x 185mm |    | 12            | 105 | 85          | 17          | 25  | 100 |
| <b>FM753C12110G</b><br>(75350b12110) | <b>FM753C12110SS</b><br>(75350012110) | M12 x 110mm | 12 | 14            | 10  | 65          | 19          | 50  | 200 |
| <b>FM753C12120G</b><br>(75350b12120) | <b>FM753C12120SS</b><br>(75350012120) | M12 x 120mm |    | 14            | 20  | 65          | 19          | 50  | 200 |
| <b>FM753C12145G</b><br>(75350b12145) | <b>FM753C12145SS</b><br>(75350012145) | M12 x 145mm |    | 14            | 45  | 85          | 19          | 25  | 100 |
| <b>FM753C12170G</b><br>(75350b12170) | <b>FM753C12170SS</b><br>(75350012170) | M12 x 170mm |    | 14            | 70  | 85          | 19          | 25  | 100 |
| <b>FM753C12200G</b><br>(75350b12200) | <b>FM753C12200SS</b><br>(75350012200) | M12 x 200mm |    | 14            | 100 | 85          | 19          | 25  | 100 |
| <b>FM753C16130G</b><br>(75350b16130) | <b>FM753C16130SS</b><br>(75350016130) | M16 x 130mm | 16 | 18            | 10  | 65          | 24          | 20  | 80  |
| <b>FM753C16150G</b><br>(75350b16150) | <b>FM753C16150SS</b><br>(75350016150) | M16 x 150mm |    | 18            | 30  | 85          | 24          | 20  | 80  |
| <b>FM753C16185G</b><br>(75350b16185) | <b>FM753C16185SS</b><br>(75350016185) | M16 x 185mm |    | 18            | 60  | 85          | 24          | 20  | 80  |
| <b>FM753C16220G</b><br>(75350b16220) | <b>FM753C16220SS</b><br>(75350016220) | M16 x 220mm |    | 18            | 100 | 85          | 24          | 15  | 60  |



ANCHORING

## SYMPAFIX® TB1-Plus Thru-Bolt



☐ Carbon Steel Class 5.8 Zinc Clear

**NEW**



ZINC INTERNAL

| Part No.     | Description        | mm | mm  | mm  | qty | qty |
|--------------|--------------------|----|-----|-----|-----|-----|
| S-TB1+08060  | 8 x 60mm (70550)   | 8  | 55  | 5   | 100 | 400 |
| S-TB1+08075  | 8 x 75mm (70552)   |    |     | 20  | 100 | 400 |
| S-TB1+08105  | 8 x 105mm (70558)  |    |     | 50  | 100 | 400 |
| S-TB1+10085  | 10 x 85mm (70562)  | 10 | 75  | 5   | 50  | 200 |
| S-TB1+10090  | 10 x 90mm (70564)  |    |     | 10  | 50  | 200 |
| S-TB1+10120  | 10 x 120mm (70570) |    |     | 40  | 50  | 200 |
| S-TB1+12090* | 12 x 90mm (70576)  | 12 | 75  | 5   | 50  | 200 |
| S-TB1+12100* | 12 x 100mm (70578) |    |     | 15  | 50  | 200 |
| S-TB1+12135* | 12 x 135mm (70582) |    |     | 50  | 25  | 100 |
| S-TB1+12185* | 12 x 185mm (70588) |    |     | 100 | 25  | 100 |
| S-TB1+16125* | 16 x 125mm (70594) | 16 | 100 | 15  | 20  | 80  |
| S-TB1+16150* | 16 x 150mm (70596) |    |     | 40  | 20  | 80  |
| S-TB1+16210* | 16 x 210mm (70600) |    |     | 100 | 10  | 40  |

\* C1 approval applies  
 - Note Product is subject to lead times, please contact your local ICCONS branch for further details

## SYMPAFIX® TB1-A4-Plus Thru-Bolt



■ Stainless Steel 316 A4

**NEW**



316 SS EXTERNAL

| Part No.   | Description        | mm | mm  | mm  | qty | qty |
|------------|--------------------|----|-----|-----|-----|-----|
| TB08075SS  | 8 x 75mm (71296)   | 8  | 60  | 10  | 100 | 400 |
| TB08100SS  | 8 x 100mm (71298)  |    |     | 35  | 100 | 400 |
| TB10065SS* | 10 x 65mm          | 10 | 45  | 10  | 100 | 400 |
| TB10090SS  | 10 x 90mm (71302)  |    |     | 75  | 50  | 200 |
| TB10120SS* | 10 x 120mm         |    |     | 75  | 40  | 200 |
| TB12080SS* | 12 x 80mm          | 12 | 60  | 10  | 50  | 200 |
| TB12100SS  | 12 x 100mm (71308) |    |     | 75  | 20  | 200 |
| TB12140SS  | 12 x 140mm (71310) |    |     | 75  | 60  | 100 |
| TB12180SS* | 12 x 180mm         |    |     | 75  | 100 | 25  |
| TB16105SS* | 16 x 105mm         | 16 | 80  | 10  | 25  | 100 |
| TB16125SS* | 16 x 125mm         |    |     | 100 | 15  | 20  |
| TB16140SS* | 16 x 140mm         |    |     | 100 | 30  | 20  |
| TB20125SS* | 20 x 125mm         | 20 | 100 | 10  | 10  | 40  |
| TB20160SS* | 20 x 160mm         |    |     | 120 | 25  | 10  |

\* Part not included in the approval



# Thru-Bolt Stud Anchor

Carbon Steel Class 5.8 Zinc Clear

Carbon Steel Class 5.8 Galvanised

ZINC

INTERNAL

GAL

EXTERNAL



| Part No. | Part No. | Description | mm | mm  | mm | qty | qty  |
|----------|----------|-------------|----|-----|----|-----|------|
| TB06085  |          | 6 x 85mm    | 6  | 50  | 26 | 100 | 1000 |
| TB06120  |          | 6 x 120mm   |    | 50  | 61 | 50  | 500  |
| TB08080  | TB08080G | 8 x 80mm    | 8  | 55  | 15 | 50  | 500  |
| TB08100  | TB08100G | 8 x 100mm   |    | 55  | 35 | 50  | 500  |
| TB10065  | TB10065G | 10 x 65mm   | 10 | 45  | 10 | 25  | 250  |
| TB10090  | TB10090G | 10 x 90mm   |    | 60  | 17 | 25  | 250  |
| TB10120  | TB10120G | 10 x 120mm  |    | 60  | 47 | 25  | 250  |
| TB12080  | TB12080G | 12 x 80mm   | 12 | 60  | 5  | 25  | 250  |
| TB12100  | TB12100G | 12 x 100mm  |    | 60  | 25 | 25  | 250  |
| TB12140  | TB12140G | 12 x 140mm  |    | 80  | 45 | 25  | 150  |
| TB12180  |          | 12 x 180mm  |    | 80  | 85 | 25  | 100  |
| TB16105  | TB16105G | 16 x 105mm  | 16 | 80  | 5  | 25  | 100  |
| TB16125  | TB16125G | 16 x 125mm  |    | 100 | 10 | 25  | 100  |
| TB16140  | TB16140G | 16 x 140mm  |    | 100 | 20 | 25  | 100  |
| TB16190  | TB16190G | 16 x 190mm  |    | 100 | 70 | 25  | 50   |
| TB20125  | TB20125G | 20 x 125mm  | 20 | 100 | 5  | 10  | 50   |
| TB20160  | TB20160G | 20 x 160mm  |    | 120 | 20 | 10  | 40   |
| TB20200  | TB20200G | 20 x 200mm  |    | 120 | 60 | 10  | 30   |





# Why choose ICCONS® Screw-bolts?

Whether you need high performing screw-bolts, NCC or for general use, ICCONS® extensive Screw-bolt range has the solution.



|  |  | VORL PERFIX  | VORL PERFIX             | VORL PERFIX              | SYMPAFIX     | THUNDERBOLT PRO                          | THUNDERBOLT    |
|--|--|--------------|-------------------------|--------------------------|--------------|--|----------------|
|  |  | Carbon steel | Stainless Steel         | Carbon Steel             | Carbon Steel | Carbon Steel                             | Carbon Steel   |
| Material / Coating                             |  | ZINC         | 316 SS                  | ZINC                     | GAL          | ZINC GAL                                 | ZINC GAL       |
| Performance                                    |  | Heavy Duty   | Heavy Duty              | Light                    | Heavy Duty   | Heavy Duty                               | Heavy Duty     |
| ETA assessment                                 |  | ✓            | ✓                       | ✓                        | ✓            |  |                |
| ETA assessment for multiple embedment depths   |  | ✓            | ✓                       |                          | ✓            |  |                |
| NCC Compliant (SA TS 101:2015)                 |  | ✓            | ✓                       | ✓                        | ✓            |  |                |
| Fire Rated                                     |  | ✓            | ✓                       | ✓                        | ✓            |  |                |
| Cracked concrete                               |  | ✓            | ✓                       | ✓                        | ✓            |  |                |
| Seismic tested                                 |  | ✓            | ✓                       |                          |              |  |                |
| Available in A4 316 stainless steel            |  |              | ✓                       |                          |              |  |                |
| Available in Galvanised Finish                 |  |              |                         |                          | ✓            | ✓  | ✓              |
| Suitable for masonry base material             |  | ✓            | ✓                       |                          | ✓            | ✓  | ✓              |
| Removable                                      |  | ✓            | ✓                       | ✓                        | ✓            | ✓  | ✓              |
| Ideal for temporary applications               |  |              |                         |                          |              | ✓  | ✓              |
| Ideal for non-safety critical applications     |  |              |                         |                          |              | ✓  | ✓              |
| Available in low profile aesthetic head finish |  | Hex Head     | Hex / Countersunk / Pan | Hex Head Internal Thread | Hex Head     | Hex Head / Countersunk / Internal Thread | Hex Head / Eye |



## SYMPAFIX® SB2 Plus Hex Head

High Tensile Boron Steel Galvanised



Serrated Cutting Lead Threads



**NEW**



GAL EXTERNAL

| Part No.                | Description | mm | mm | mm | mm | qty | qty |
|-------------------------|-------------|----|----|----|----|-----|-----|
| S-SB2+08050G<br>(70464) | 8 x 50mm    | 8  | 45 | 5  | 13 | 50  | 400 |
| S-SB2+08075G<br>(70465) | 8 x 75mm    |    |    | 30 |    | 50  | 400 |
| S-SB2+10075G<br>(70472) | 10 x 75mm   | 10 | 50 | 25 | 15 | 50  | 200 |
| S-SB2+10100G<br>(70474) | 10 x 100mm  |    |    | 50 |    | 50  | 200 |
| S-SB2+12100G<br>(70480) | 12 x 100mm  | 12 | 50 | 50 | 16 | 25  | 100 |



**ANCHORING**



**TOGE TSM High Performance Screw-bolts Hex Head**

☐ Carbon Steel Zinc Clear

■ Stainless Steel 316 A4



**NEW**

ZINC INTERNAL

316 SS EXTERNAL



| Part No. | Part No.   | Description | mm | mm | mm | mm | qty | qty |
|----------|------------|-------------|----|----|----|----|-----|-----|
| TSM06050 | TSM06050SS | 6 x 50mm    | 6  | 35 | 15 | 13 | 100 | n/a |
|          | TSM06060SS | 6 x 60mm    |    |    | 25 |    | 100 | n/a |
| TSM06080 |            | 6 x 80mm    |    |    | 45 |    | 100 | n/a |
|          | TSM08070SS | 8 x 70mm    | 8  | 45 | 25 | 13 | 50  | n/a |
| TSM08080 | TSM08080SS | 8 x 80mm    |    |    | 35 |    | 50  | n/a |
|          | TSM10090SS | 10 X 90mm   | 10 | 55 | 35 | 15 | 50  | n/a |
| TSM10100 | TSM10100SS | 10 X 100mm  |    |    | 45 |    | 50  | n/a |
|          | TSM10120SS | 10 X 120mm  |    |    | 65 |    | 50  | n/a |
| TSM12110 |            | 12 X 110mm  | 12 | 65 | 45 | 17 | 25  | n/a |
| TSM14150 |            | 14 x 150mm  | 14 | 75 | 75 | 21 | 25  | n/a |



**TOGE TSM High Performance Screw-bolts Countersunk**

■ Stainless Steel 316 A4



316 SS EXTERNAL



| Part No.    | Description | mm | mm | mm | mm          | qty | qty |
|-------------|-------------|----|----|----|-------------|-----|-----|
| TSMC06050SS | 6 x 50mm    | 6  | 35 | 15 | TX30 / VZ30 | 100 | n/a |
| TSMC06065SS | 6 x 65mm    |    |    | 30 |             | 100 | n/a |
| TSMC06085SS | 6 x 85mm    |    |    | 50 |             | 100 | n/a |
| TSMC06105SS | 6 x 105mm   |    |    | 70 |             | 100 | n/a |
| TSMC08080SS | 8 x 80mm    | 8  | 45 | 35 | TX40 / VZ40 | 50  | n/a |
| TSMC10090SS | 10 X 90mm   | 10 | 55 | 35 | TX50 / VZ50 | 50  | n/a |



**TOGE TSM High Performance Screw-bolts Pan Head**

■ Stainless Steel 316 A4



316 SS EXTERNAL



| Part No.    | Description | mm | mm | mm | mm          | qty | qty |
|-------------|-------------|----|----|----|-------------|-----|-----|
| TSMP06050SS | 6 x 50mm    | 6  | 35 | 15 | TX30 / VZ30 | 100 | n/a |
| TSMP06060SS | 6 x 60mm    |    |    | 25 |             | 100 | n/a |
| TSMP06080SS | 6 x 80mm    |    |    | 45 |             | 100 | n/a |
| TSMP06100SS | 6 x 100mm   |    |    | 65 |             | 100 | n/a |





## THUNDERBOLT<sup>PRO</sup>

Stamped Cold Forged head for fast and accurate anchor identification.

Industry-Standard Large hex head ensures secure connection.

Underside of head features Anti-rotation design to resist loosening and improves Dynamic Load Performance.

Chamfered tip centres anchor and aids installation.

10/60

15° HI-LOW double lead thread has been optimised to provide fast installation while maintaining a high level of thread engagement.

10 Hardened Thread Cutting Teeth reduce installation torque and ensure deep thread formation in the hardest base materials.

Asymmetric thread profile provides unparalleled "bite" in concrete.

High Tensile Boron Steel Zinc Yellow      High Tensile Boron Steel Galvanised



### ThunderBolt<sup>PRO</sup> Hex Head

■ High Tensile Boron Steel Zinc Yellow

■ High Tensile Boron Steel Galvanised



| ZINC INTERNAL |            | GAL EXTERNAL |    |    |    |    |     |     |  |
|---------------|------------|--------------|----|----|----|----|-----|-----|--|
| Part No.      | Part No.   | Description  | mm | mm | mm | mm | qty | qty |  |
| SXTB08050     | SXTB08050G | 8 x 50mm     |    | 40 | 10 | 13 | 100 | 600 |  |
| SXTB08060     | SXTB08060G | 8 x 60mm     |    |    | 20 |    | 100 | 600 |  |
| SXTB08075     | SXTB08075G | 8 x 75mm     |    |    | 35 |    | 100 | 500 |  |
| SXTB08100     | SXTB08100G | 8 x 100mm    |    |    | 60 |    | 100 | 400 |  |
| SXTB10060     | SXTB10060G | 10 x 60mm    | 10 | 50 | 10 | 17 | 50  | 250 |  |
| SXTB10075     | SXTB10075G | 10 x 75mm    |    |    | 25 |    | 50  | 250 |  |
| SXTB10100     | SXTB10100G | 10 x 100mm   |    |    | 50 |    | 50  | 250 |  |
| SXTB10120     | SXTB10120G | 10 x 120mm   |    |    | 70 |    | 50  | 250 |  |
| SXTB12075     | SXTB12075G | 12 x 75mm    | 12 | 60 | 15 | 19 | 50  | 150 |  |
| SXTB12100     | SXTB12100G | 12 x 100mm   |    |    | 40 |    | 50  | 150 |  |
| SXTB12120     | SXTB12120G | 12 x 120mm   |    |    | 60 |    | 25  | 125 |  |
| SXTB12150     | SXTB12150G | 12 x 150mm   |    |    | 90 |    | 25  | 75  |  |
| SXTB16100     | SXTB16100G | 16 x 100mm   | 16 | 80 | 20 | 24 | 15  | 60  |  |
| SXTB16150     | SXTB16150G | 16 x 150mm   |    |    | 70 |    | 15  | 60  |  |

### ThunderBolt<sup>PRO</sup> Tie-Down Anchor

■ High Tensile Boron Steel Zinc Yellow



| ZINC INTERNAL |  |    |     |    |    |     |     |
|---------------|--|----|-----|----|----|-----|-----|
| Part No.      | Description  | mm | mm  | mm | mm | qty | qty |
| SXTBTD12100   | 12 x 100mm Tie-Downs for Timber & Metal Frame Structures | 12 | M12 | 40 | 19 | 25  | 100 |
| SXTBTD12150   | 12 x 150mm Tie-Downs for Timber & Metal Frame Structures | 12 | M12 | 90 | 19 | 25  | 100 |





## ANCHORING



# Black-Tip ThunderBolt® Hex Head

■ High Tensile Boron Steel Zinc Yellow

■ High Tensile Boron Steel Galvanised

ZINC

INTERNAL

GAL

EXTERNAL



| Part No. | Part No.  | Description | mm | mm | mm | mm | qty | qty  |
|----------|-----------|-------------|----|----|----|----|-----|------|
| SXB05050 | SXB05050G | 5 x 50mm    | 5  | 35 | 25 | 8  | 100 | 1600 |
| SXB06030 | SXB06030G | 6 x 30mm    | 6  | 25 | 5  | 10 | 100 | 1600 |
| SXB06050 | SXB06050G | 6 x 50mm    |    | 30 | 20 |    | 100 | 1200 |
| SXB06075 | SXB06075G | 6 x 75mm    |    |    | 45 |    | 100 | 600  |
| SXB06100 | SXB06100G | 6 x 100mm   |    |    | 55 |    | 100 | 600  |
| SXB08050 | SXB08050G | 8 x 50mm    | 8  | 40 | 10 | 13 | 100 | 600  |
| SXB08060 | SXB08060G | 8 x 60mm    |    |    | 20 |    | 100 | 600  |
| SXB08075 | SXB08075G | 8 x 75mm    |    |    | 35 |    | 100 | 500  |
| SXB08100 | SXB08100G | 8 x 100mm   |    |    | 60 |    | 100 | 400  |
| SXB10060 | SXB10060G | 10 x 60mm   | 10 | 50 | 10 | 15 | 50  | 300  |
| SXB10075 | SXB10075G | 10 x 75mm   |    |    | 25 |    | 50  | 300  |
| SXB10100 | SXB10100G | 10 x 100mm  |    |    | 50 |    | 50  | 200  |
| SXB10130 | SXB10120G | 10 x 120mm  |    |    | 80 |    | 25  | 150  |
| SXB12075 | SXB12075G | 12 x 75mm   | 12 | 60 | 15 | 16 | 50  | 200  |
| SXB12100 | SXB12100G | 12 x 100mm  |    |    | 40 |    | 50  | 150  |
| SXB12150 | SXB12150G | 12 x 150mm  |    |    | 90 |    | 20  | 120  |
| SXB16100 | SXB16100G | 16 x 100mm  | 16 | 80 | 20 | 21 | 15  | 90   |
| SXB16150 | SXB16150G | 16 x 150mm  |    |    | 70 |    | 10  | 60   |



# Black-Tip ThunderBolt® EYE

■ High Tensile Boron Steel Zinc Yellow

ZINC

INTERNAL



| Part No.     | Description | mm | mm | mm     | qty | qty |
|--------------|-------------|----|----|--------|-----|-----|
| SXB EYE12075 | 12 x 75mm   | 12 | 60 | 20 Int | 20  | 120 |

\* Not recommended for lifting



**HIGH PERFORMANCE AESTHETIC COUNTERSUNK SCREW-BOLT**

**THUNDERBOLT<sup>®</sup> PRO**

**GALVANISED**

15° HI-LOW double lead thread has been optimised to provide fast installation while maintaining a high level of thread engagement.

10 Hardened Thread Cutting Teeth reduce installation torque and ensure deep thread formation in the hardest base materials.

Chamfered tip centres anchor and aids installation.

**NAUTILUS<sup>®</sup> EXTEND<sup>4</sup>**

**HIGH TENSILE**



### ThunderBolt<sup>®</sup> Pro Countersunk Head

High Tensile Boron Steel Galvanised

DRIVER BIT INCLUDED



**NEW**

| Part No.     | Description | mm | mm | mm  | mm | mm | Drive Int Hex | qty | qty  |
|--------------|-------------|----|----|-----|----|----|---------------|-----|------|
| SXTBCS06050G | 6 x 50mm    | 6  | 25 | 25  | 16 | 6  | 5mm           | 100 | 1200 |
| SXTBCS06075G | 6 x 75mm    |    |    | 50  |    |    |               | 100 | 600  |
| SXTBCS08060G | 8 x 60mm    | 8  | 35 | 15  | 21 | 8  | 6mm           | 100 | 600  |
| SXTBCS08075G | 8 x 75mm    |    |    | 40  |    |    |               | 100 | 500  |
| SXTBCS08100G | 8 x 100mm   |    |    | 65  |    |    |               | 100 | 400  |
| SXTBCS10060G | 10 x 60mm   | 10 | 40 | 20  | 25 | 9  | 8mm           | 100 | 400  |
| SXTBCS10075G | 10 x 75mm   |    |    | 35  |    |    |               | 50  | 300  |
| SXTBCS10100G | 10 x 100mm  |    |    | 60  |    |    |               | 50  | 300  |
| SXTBCS12075G | 12 x 75mm   | 12 | 50 | 25  | 28 | 10 | 10mm          | 50  | 200  |
| SXTBCS12100G | 12 x 100mm  |    |    | 50  |    |    |               | 50  | 150  |
| SXTBCS12150G | 12 x 150mm  |    |    | 100 |    |    |               | 20  | 120  |





# NEW Brushless Impact "2 in 1" Tool



Tool holder accepts both 1/4" internal hex for driver bits and a 1/2" external for sockets.



## Now With a 5.0Ah Battery

18V | 5.0Ah quick charge lithium batteries

for Full Specs see page195

**LITHIUM**  
Long Life **-ION**

**BLDC**  
BRUSHLESS  
MOTOR

**KEYANG**





## ANCHORING

# Sleeve Anchor Hex Head

■ Carbon Steel Zinc Yellow

■ Carbon Steel Galvanised

■ Stainless Steel 316 A4



ZINC INTERNAL

GAL EXTERNAL

316 SS EXTERNAL

| Part No. | Part No. | Part No.  | Description | mm  | mm | mm | qty | qty  |
|----------|----------|-----------|-------------|-----|----|----|-----|------|
| SA06525  |          |           | 6.5 x 25mm  | 6.5 | 20 | 5  | 100 | 1000 |
| SA06535  |          | SA06535SS | 6.5 x 35mm  |     | 30 | 5  | 100 | 1000 |
| SA06555  |          | SA06555SS | 6.5 x 55mm  |     |    | 25 | 100 | 1000 |
| SA06575  |          | SA06575SS | 6.5 x 75mm  |     |    | 45 | 100 | 1000 |
| SA08040  | SA08040G | SA08040SS | 8 x 40mm    | 8   | 35 | 5  | 100 | 1000 |
| SA08065  | SA08065G | SA08065SS | 8 x 65mm    |     |    | 30 | 50  | 500  |
| SA08085  | SA08085G | SA08085SS | 8 x 85mm    |     |    | 50 | 50  | 500  |
| SA10040  | SA10040G | SA10040SS | 10 x 40mm   | 10  | 34 | 6  | 50  | 500  |
| SA10050  | SA10050G | SA10050SS | 10 x 50mm   |     | 40 | 10 | 50  | 500  |
| SA10060  | SA10060G | SA10060SS | 10 x 60mm   |     |    | 20 | 50  | 500  |
| SA10075  | SA10075G | SA10075SS | 10 x 75mm   |     |    | 35 | 50  | 500  |
| SA10095  | SA10095G | SA10095SS | 10 x 95mm   |     |    | 55 | 50  | 400  |
| SA10120  |          |           | 10 x 120mm  |     |    | 80 | 50  | 300  |
| SA12060  | SA12060G | SA12060SS | 12 x 60mm   | 12  | 50 | 10 | 50  | 400  |
| SA12075  | SA12075G | SA12075SS | 12 x 75mm   |     |    | 25 | 25  | 250  |
| SA12100  | SA12100G | SA12100SS | 12 x 100mm  |     |    | 50 | 25  | 250  |
| SA12130  | SA12130G |           | 12 x 130mm  |     |    | 80 | 25  | 200  |
| SA16065  | SA16065G |           | 16 x 65mm   | 16  | 55 | 10 | 25  | 200  |
| SA16110  | SA16110G |           | 16 x 110mm  |     |    | 55 | 10  | 100  |
| SA16145  |          |           | 16 x 145mm  |     |    | 90 | 10  | 100  |
| SA20075  |          |           | 20 x 75mm   | 20  | 60 | 15 | 10  | 100  |
| SA20105  |          |           | 20 x 105mm  |     |    | 45 | 10  | 60   |
| SA20150  |          |           | 20 x 150mm  |     |    | 90 | 10  | 60   |

# Countersunk Post Head

■ Stainless Steel 316 A4

Countersunk Internal threaded head for use in conversion of stainless steel hex head sleeve anchors to an aesthetic countersunk head style



316 SS EXTERNAL

| Part No.  | Description  | mm  | mm | mm  | mm | qty | qty  |
|-----------|--|-----|----|-----|----|-----|------|
| SAPH065SS | M5 Internal Thread (suits 6.5mm SS sleeve anchor)  | 6.5 | 12 | 3.5 | M5 | 100 | 1000 |
| SAPH08SS  | M6 Internal Thread (suits 8.0mm SS sleeve anchor)  | 8   | 14 | 4   | M6 | 100 | 1000 |
| SAPH10SS  | M8 Internal Thread (suits 10.0mm SS sleeve anchor) | 10  | 16 | 4   | M8 | 100 | 1000 |



## ANCHORING



### Sleeve Anchor Flush Head

■ Carbon Steel Zinc Yellow

■ Stainless Steel 316 A4

| Part No. | Part No.   | Description | mm | mm | mm | qty | qty  |
|----------|------------|-------------|----|----|----|-----|------|
| SAF08045 | SAF08045SS | 8 x 45mm    | 8  | 35 | 10 | 100 | 1000 |
| SAF08070 | SAF08070SS | 8 x 70mm    |    |    | 35 | 50  | 500  |
| SAF08090 | SAF08090SS | 8 x 90mm    |    |    | 55 | 50  | 500  |
|          | SAF10040SS | 10 x 40mm   | 10 | 34 | 6  | 50  | 500  |
| SAF10045 |            | 10 x 45mm   |    | 40 | 5  | 50  | 500  |
| SAF10055 |            | 10 x 55mm   |    |    | 15 | 50  | 500  |
|          | SAF10060SS | 10 x 60mm   |    |    | 20 | 50  | 500  |
| SAF10065 |            | 10 x 65mm   |    |    | 25 | 50  | 500  |
|          | SAF10075SS | 10 x 75mm   |    |    | 35 | 50  | 500  |
| SAF10085 |            | 10 x 85mm   |    |    | 40 | 50  | 500  |
|          | SAF10095SS | 10 x 95mm   |    |    | 55 | 50  | 400  |
| SAF10100 |            | 10 x 100mm  |    |    | 60 | 50  | 400  |
| SAF12065 |            | 12 x 65mm   | 12 | 50 | 15 | 50  | 300  |
| SAF12080 |            | 12 x 80mm   |    |    | 30 | 25  | 250  |
|          | SAF12075SS | 12 x 75mm   |    |    | 25 | 25  | 250  |
| SAF12105 |            | 12 x 105mm  |    |    | 55 | 25  | 250  |
| SAF16075 |            | 16 x 75mm   | 16 | 60 | 15 | 25  | 200  |
| SAF16110 |            | 16 x 110mm  |    |    | 50 | 10  | 100  |

### Sleeve Anchor Countersunk Head

■ Carbon Steel Zinc Yellow



| Part No.    | Description | mm  | Drive | mm | mm | qty | qty  |
|-------------|-------------|-----|-------|----|----|-----|------|
| SACSK065035 | 6.5 x 35mm  | 6.5 | PH3   | 30 | 5  | 100 | 1000 |
| SACSK065055 | 6.5 x 55mm  |     | PH3   |    | 25 | 100 | 1000 |
| SACSK065075 | 6.5 x 75mm  |     | PH3   |    | 45 | 100 | 1000 |
| SACSK065100 | 6.5 x 100mm |     | PH3   |    | 70 | 100 | 1000 |
| SACSK08060  | 8 x 60mm    | 8   | PH3   | 35 | 25 | 50  | 500  |
| SACSK08085  | 8 x 85mm    |     | PH3   |    | 50 | 50  | 500  |
| SACSK10075  | 10 x 75mm   | 10  | PH3   | 40 | 35 | 50  | 500  |
| SACSK10100  | 10 x 100mm  |     | PH3   |    | 60 | 50  | 400  |
| SACSK10120  | 10 x 120mm  |     | PH3   |    | 80 | 50  | 400  |



**ANCHORING**



## Sleeve Anchor

Suspension, Eye & Hook Bolt

■ Suspension Carbon Steel Zinc Yellow

■ Eye Bolt Carbon Steel Zinc Yellow

■ Hook Bolt Carbon Steel Zinc Yellow



ZINC INTERNAL    ZINC INTERNAL    ZINC INTERNAL



| Part No.   | Part No. | Part No. | Description | mm  | mm | mm | qty | qty  |
|------------|----------|----------|-------------|-----|----|----|-----|------|
| SASUS06525 |          |          | 6.5 x 25mm  | 6.5 | 25 | 7  | 100 | 1000 |
| SASUS06535 |          |          | 6.5 x 35mm  | 6.5 | 35 | 7  | 100 | 1000 |
|            | SAEB0845 | SAHB0845 | 8.0 x 45mm  | 8.0 | 45 | 8  | 100 | 1000 |



## Tie Wire Thru-Bolt

■ Carbon Steel Zinc Yellow



ZINC INTERNAL



| Part No.  | Description                    | mm | mm | mm | qty | qty  |
|-----------|--------------------------------|----|----|----|-----|------|
| TWTB06060 | 6.0 x 60mm Tie wire Thru-Bolt  | 6  | 40 | 6  | 100 | 1000 |
| TWTB06090 | 6.0 x 90mm Tie wire Thru-Bolt  |    |    |    | 100 | 1000 |
| TWTB06120 | 6.0 x 120mm Tie wire Thru-Bolt |    |    |    | 50  | 500  |
| TWTB06150 | 6.0 x 150mm Tie wire Thru-Bolt |    |    |    | 100 | 800  |



## Eyelet Purlin Screw

■ Carbon Steel Zinc Yellow

ZINC INTERNAL



| Part No. | Description   | mm        | mm | qty | qty  |
|----------|---|-----------|----|-----|------|
| EPSN     | 1/4" - 14 x 22mm Eyelet Purlin Screw with EPDM washer | 1.2 - 1.6 | 4  | 250 | 1000 |



## Eyelet Purlin Screw Socket Driver

For use with Eyelet Purlin Screw



| Part No. | Description                       | qty |
|----------|-----------------------------------|-----|
| EPSSD    | Eyelet Purlin Screw Socket Driver | 1   |





ANCHORING



**TOGE TSO**  
Suspension Spring Anchor



**NEW**

- Carbon Steel Zinc Clear
- Easily installs by hand



ZINC INTERNAL



| Part No. | Description                     | mm | mm | qty | qty |
|----------|---------------------------------|----|----|-----|-----|
| TSO06040 | 6 x 40 suspension spring anchor | 6  | 10 | 100 | n/a |

**Tie Wire Post Head**



- Carbon Steel Zinc Clear

ZINC INTERNAL



| Part No. | Description                                   | mm  | mm | qty | qty |
|----------|---|-----|----|-----|-----|
| TWPH08*  | M8 Internal threaded tie wire head <b>NEW</b> | M8  | 10 | TBA | TBA |
| TWPH10   | M10 Internal threaded tie wire head           | M10 | 10 | 150 | 600 |

\* available upon request

**Strike™ Anchor Tie-Wire Ceiling Hanger**



- Carbon Steel Zinc Clear

ZINC INTERNAL



| Part No. | Description                    | mm  | mm | mm  | qty | qty  |
|----------|--------------------------------|-----|----|-----|-----|------|
| STTW05   | 5.0 mm Tie Wire Strike™ Anchor | 5   | 30 | 5.5 | 100 | 1000 |
| STTW65   | 6.5 mm Tie Wire Strike™ Anchor | 6.5 | 25 | 7   | 100 | 1000 |

\* Also referenced on Page 42

**Steel Purlin Vertical Flange Clip**



- Zinc Yellow

ZINC INTERNAL



| Part No. | Description  | mm        | qty | qty  |
|----------|--|-----------|-----|------|
| VFC      | 1.6 - 2.5mm Steel purlin Vertical flange Clip for steel purlin | 1.6 - 2.5 | 100 | 2400 |



**ANCHORING**

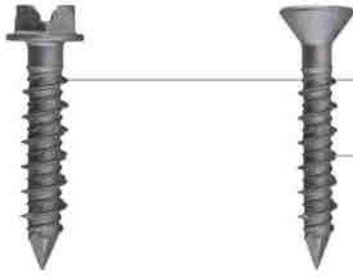

## Grabcon® Hex Head & Countersunk

■ Hex Head Grabcon® - Carbon Steel Galvanised

■ Countersunk Grabcon® - Carbon Steel Galvanised

| Part No.             | Drive    | Description                           | Inch   | mm | mm  | qty | qty  |
|----------------------|----------|---------------------------------------|--------|----|-----|-----|------|
| <b>GCCSK05032</b>    | PH2      | 5 x 32 Masonry Screw (3/16 x 1-1/4")  | *5/32" | 25 | 5   | 100 | 2500 |
| <b>GCCSK05045</b>    | PH2      | 5 x 45 Masonry Screw (3/16 x 1-3/4")  |        |    |     | 100 | 2500 |
| <b>GCCSK05058</b>    | PH2      | 5 x 58 Masonry Screw (3/16 x 2-1/4")  |        |    |     | 100 | 1600 |
| <b>GCCSK05070</b>    | PH2      | 5 x 70 Masonry Screw (3/16 x 2-3/4")  |        |    |     | 100 | 1000 |
| <b>GCHX65032</b>     | Hex 5/16 | 6.5 x 32 Masonry Screw (1/4 x 1-1/4") | *3/16" | 25 | 6.5 | 100 | 2500 |
| <b>GCHX65045</b>     | Hex 5/16 | 6.5 x 45 Masonry Screw (1/4 x 1-3/4") |        |    |     | 100 | 1600 |
| <b>GCHX65058</b>     | Hex 5/16 | 6.5 x 58 Masonry Screw (1/4 x 2-1/4") |        |    |     | 100 | 1000 |
| <b>GCHX65070</b>     | Hex 5/16 | 6.5 x 70 Masonry Screw (1/4 x 2-3/4") |        |    |     | 100 | 1000 |
| <b>GCHX65083 NEW</b> | Hex 5/16 | 6.5 x 83 Masonry Screw (1/4 x 3-1/4") |        |    |     | 100 | 600  |
| <b>GCHX65100 NEW</b> | Hex 5/16 | 6.5 x 100 Masonry Screw (1/4 x 4")    |        |    |     | 100 | 600  |

Note drill bit included in each box



**GRABCON®**  
CONCRETE FRAMING SCREW

**FREE!**  
TX40  
Driver bit  
Included

### Fast, Efficient Bottom Plate Fixing!

- For fixing timber to concrete or brick/ blockwork
- Domed washed head for high clamping force
- Non-expansion for close to concrete edge
- Can also be used for timber to timber applications
- Fully removable design (nothing left in the concrete)

Performance derived in accordance with AS 1720.1 - 2010 (timber Structures)



## Grabcon® Frame

**NEW**

□ Grabcon® Concrete Framing Screw - Zinc Clear



| Part No.        | Description                    | mm | drive | mm       | qty | qty  |
|-----------------|--------------------------------|----|-------|----------|-----|------|
| <b>GCF06102</b> | 6 x 102mm Concrete frame screw | 6  | T40   | up to 45 | 100 | 1000 |



# SYMPAFIX® Door & Window Screws



Carbon Steel Zinc Clear



ZINC INTERNAL



| Part No.                    | Description |            | mm | mm | Torx | qty | qty  |
|-----------------------------|-------------|------------|----|----|------|-----|------|
| <b>SKSZ06062</b><br>(99955) | 6 x 62mm    | <b>NEW</b> | 6  | 22 | T30  | 100 | 1000 |
| <b>SKSZ06072</b><br>(70962) | 6 x 72mm    |            | 6  | 42 | T30  | 100 | 400  |
| <b>SKSZ06092</b><br>(70964) | 6 x 92mm    |            | 6  | 62 | T30  | 100 | 400  |
| <b>SKSZ06112</b><br>(70966) | 6 x 112mm   |            | 6  | 82 | T30  | 50  | 200  |

# SYMPAFIX® Presse Nails



Spring Steel Zinc Clear



ZINC INTERNAL



| Part No.                   | Description |  | mm | mm | qty | qty  |
|----------------------------|-------------|--|----|----|-----|------|
| <b>SXN06040</b><br>(70844) | 6 x 40mm    |  | 6  | 10 | 200 | 2000 |
| <b>SXN06050</b><br>(70846) | 6 x 50mm    |  | 6  | 20 | 200 | 2000 |
| <b>SXN06060</b><br>(70848) | 6 x 60mm    |  | 6  | 30 | 200 | 2000 |
| <b>SXN06080</b><br>(70850) | 6 x 80mm    |  | 6  | 50 | 100 | 1000 |

# FIXING COMPLIANT



National Code Compliant



European Technical Assessment



Cracked Concrete Approved



Seismic Approved Fasteners



Seismic Approved Fasteners



Fire Rated Fasteners

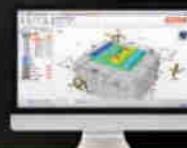

FREE Software Download

SA TS 101:2015 - the new Standards Australia Technical Specification for Post-Installed Fasteners is NOW referenced in the 2016 NCC  
**Complying with the 2016 National Construction Code is Law!**





## ANCHORING



### Lip Drop-in Anchor

Carbon Steel Zinc Clear

ZINC INTERNAL



| Part No. | Description                              | mm | mm | metric | qty | qty |
|----------|--|----|----|--------|-----|-----|
| DLPM1025 | M10 x 25mm Lip Drop-in anchor            | 12 | 27 | M10    | 50  | 500 |
| DLPM1030 | M10 x 30mm Lip Drop-in anchor <b>NEW</b> | 12 | 32 | M10    | 50  | 500 |
| DLPM1040 | M10 x 40mm Lip Drop-in anchor            | 12 | 42 | M10    | 50  | 400 |
| DLPM1225 | M12 x 25mm Lip Drop-in anchor            | 15 | 27 | M12    | 50  | 300 |
| DLPM1250 | M12 x 50mm Lip Drop-in anchor <b>NEW</b> | 15 | 52 | M12    | 50  | 300 |



### Lip Drop-in Anchor Bucket

Carbon Steel Zinc Clear  
Bucket Includes 2 x short drill bits & 1 x setting tool.

ZINC INTERNAL



| Part No.       | Description   | mm | mm | metric | qty | qty  |
|----------------|---|----|----|--------|-----|------|
| DLPM1025BK     | M10 x 25mm Lip Drop-in anchor Bucket                            | 12 | 27 | M10    | 500 | 1000 |
| DLPM1025BK-SDS | M10 x 25mm Lip Drop-in anchor Bucket with SDS Plus setting tool | 12 | 27 | M10    | 500 | 1000 |
| DLPM1030BK     | M10 x 30mm Lip Drop-in anchor Bucket                            | 12 | 32 | M10    | 500 | 1000 |
| DLPM1030BK-SDS | M10 x 30mm Lip Drop-in anchor Bucket with SDS Plus setting tool | 12 | 32 | M10    | 500 | 1000 |
| DLPM1040BK     | M10 x 40mm Lip Drop-in anchor Bucket                            | 12 | 42 | M10    | 500 | 1000 |
| DLPM1250BK     | M12 x 50mm Lip Drop-in anchor Bucket                            | 15 | 52 | M12    | 200 | 400  |



### Lip Drop-in Setting Tool

For use with Lip Drop-In Anchors.



| Part No. | Description  | qty |
|----------|--|-----|
| DLST1030 | M10 x 25mm & M10 x 30mm Lip Drop-in setting tool - Soft grip | 1   |
| DLST1250 | M12 x 50mm Lip Drop-in setting tool - Soft grip              | 1   |

### SDS PLUS Drill Bits & Setting Tool



SDS Plus Drill Bits for use with Lip Drop-In Anchors.



Setting tool Kit for use with M10 x 25 & M10 x 30 Lip Drop-in Anchors only



| Part No.     | Description  | qty |
|--------------|--|-----|
| DLSDS1245    | 12 x 45mm SDS Drill bit for M10 x 25 & M10 x 30 mm Lip Drop-in   | 1   |
| DLSDS1560    | 15 x 60mm SDS Drill bit for M12 x 50 mm Lip Drop-in  | 1   |
| DLSDS-ST1030 | SDS setting tool kit for 10 x 25mm & 10 x 30mm Lip Drop-in, includes: 1 x 45mm Drill Bit, 1 x Setting Tool Adaptor | 1   |

**NEW**

## SYMPAFIX® Di-Plus Drop-in Anchor

☐ Carbon Steel Zinc Clear



ZINC INTERNAL



| Part No.        | Description               | mm | mm | metric | qty | qty |
|-----------------|---------------------------|----|----|--------|-----|-----|
| *DM08-A (70780) | M8 x 30mm Drop-in anchor  | 10 | 32 | M8     | 100 | 800 |
| DM10-A (70782)  | M10 x 40mm Drop-in anchor | 12 | 42 | M10    | 100 | 800 |
| DM12-A (70784)  | M12 x 50mm Drop-in anchor | 16 | 52 | M12    | 100 | 400 |

\*Lead times may apply



## Standard Drop-in Anchor

■ Carbon Steel Zinc Yellow

■ Stainless Steel 316 A4

ZINC INTERNAL

316 SS EXTERNAL



| Part No. | Part No. | Description               | mm | mm | metric | qty | qty  |
|----------|----------|---------------------------|----|----|--------|-----|------|
| DM06     |          | M6 x 25mm Drop-in anchor  | 8  | 27 | M6     | 100 | 1000 |
| DM08     | DM08SS   | M8 x 30mm Drop-in anchor  | 10 | 32 | M8     | 100 | 1000 |
| DM10     | DM10SS   | M10 x 40mm Drop-in anchor | 12 | 42 | M10    | 50  | 500  |
| DM12     | DM12SS   | M12 x 50mm Drop-in anchor | 15 | 52 | M12    | 50  | 400  |
| DM16     | DM16SS   | M16 x 65mm Drop-in anchor | 20 | 67 | M16    | 25  | 100  |
| DM20     |          | M20 x 80mm Drop-in anchor | 25 | 82 | M20    | 25  | 50   |

## Drop-in Setting Tool



For use with standard non-lip Drop-In Anchors.



| Part No. | Description                               | qty          |
|----------|---|--------------|
| DST06    | Suits M6 Standard Drop-In anchors         | 1            |
| DST08    | Suits M8 Standard Drop-In anchors         | 1            |
| DST10    | Suits M10 Standard Drop-In anchors        | 1            |
| DST12-25 | Suits M12 for 25mm Lipped Drop-In anchors | <b>NEW</b> 1 |
| DST12    | Suits M12 Standard Drop-In anchors        | 1            |
| DST16    | Suits M16 Standard Drop-In anchors        | 1            |
| DST20    | Suits M20 Standard Drop-In anchors        | 1            |



**ANCHORING**

## Hangerz™ for Concrete



Carbon Steel Zinc Clear



ZINC INTERNAL



| Part No.              | Description   | mm | mm | metric | mm | qty | qty |
|-----------------------|---|----|----|--------|----|-----|-----|
| <b>HZCVM10</b>        | M10 x 40mm Rod Hanger for Concrete  | 6  | 40 | M10    | 13 | 100 | 500 |
| <b>HZCVM10-BUCKET</b> | Hangerz™ Concrete M10 500 PCE - (includes 3 x Drill Bits, 1 x Socket, 1 x Sleeve) |    |    |        |    |     | 1   |



## Hangerz™ For Concrete Socket Driver & Adaptor

Socket Driver for use with Hangerz™ for Concrete

Drill bit & Adaptor for use with Hangerz™ for Concrete

CONCRETE



| Part No.        | Part No.       | Description                             | qty |
|-----------------|----------------|---|-----|
| <b>HZCM10-D</b> |                | Hangerz™ Socket Driver for Concrete M10 | 1   |
|                 | <b>HZ6MD-D</b> | Hangerz™ SDS Driver Adaptor             | 1   |
|                 | <b>HZ6MD</b>   | Hangerz™ SDS Drill 6mm x 150mm          | 1   |



## Hangerz™ for Steel

Side Mount Zinc Clear

Vertical Mount Zinc Clear

Socket Driver for use with Hangerz™ for Steel / Timber

ZINC INTERNAL

ZINC INTERNAL



| Part No.       | Part No.       | Part No.       | Description                          | metric | mm        | qty | qty |
|----------------|----------------|----------------|--------------------------------------|--------|-----------|-----|-----|
| <b>HZSSM10</b> | <b>HZSVM10</b> |                | M10 Rod Hanger For Steel substrates  | M10    | 1.0 - 3.0 | 100 | 500 |
|                |                | <b>HZSM10D</b> | Hangerz™ Socket Driver for Steel M10 |        |           | 1   |     |



## Hangerz™ for Timber

Vertical Mount Zinc Clear

Socket Driver for use with Hangerz™ for Timber / Steel

**NEW**

ZINC INTERNAL



| Part No.         | Part No.       | Description                           | metric | mm | qty | qty |
|------------------|----------------|---------------------------------------|--------|----|-----|-----|
| <b>HZTV25M10</b> |                | M10 Rod Hanger For Timber substrates  | M10    | 25 | 100 | 500 |
|                  | <b>HZSM10D</b> | Hangerz™ Socket Driver for Timber M10 |        |    | 1   | n/a |





**ANCHORING**

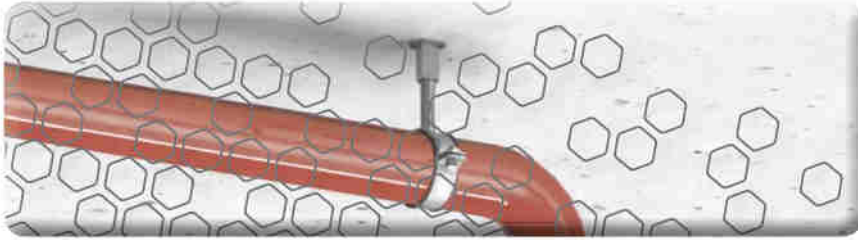

**TOGE TSM IM**



Carbon Steel Zinc Clear

**NEW**



| ZINC GREY INTERNAL                   |                                     | ZINC GREY INTERNAL |   | GAL |    |           |        |    |     |  |
|--------------------------------------|-------------------------------------|--------------------|---|-----|----|-----------|--------|----|-----|--|
| Part No.                             | Part No.                            | Part No.           | Description                               | mm  | mm | metric    | metric | mm | qty |  |
| <b>TSMIM06055ZG</b><br>(210 060 600) |                                     |                    | 6 X 55 Hanger (M8/M10 internal thread)    | 6   | 55 | M8 / M10  |        | 13 | 50  |  |
|                                      | <b>TSMB06055ZG</b><br>(355 006 055) |                    | 6 X 55 Hanger (M8 External thread)        | 6   | 55 |           | M8     | 10 | 100 |  |
|                                      |                                     | <b>CPLRM8-M12</b>  | M8 to M12 coupler nut for M12 Rod Hanging |     |    | M8 to M12 |        | 16 | 100 |  |

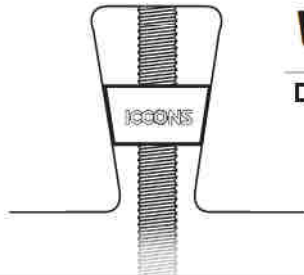

**Wedge-Nut**

For use in Bondek® Profile - Zinc Clear

| ZINC INTERNAL |                     |        |     |      |
|---------------|---------------------|--------|-----|------|
| Part No.      | Description         | metric | qty | qty  |
| <b>WNM6</b>   | M6 Nut For Bondek®  | M6     | 100 | 1000 |
| <b>WNM10</b>  | M10 Nut For Bondek® | M10    | 100 | 1000 |



**Beam Clamp**

Rod Hanger

Approvals



| ZINC INTERNAL |                           |    |              |     |     |
|---------------|---------------------------|----|--------------|-----|-----|
| Part No.      | Description               | mm | clearance/mm | qty | qty |
| <b>TKN10</b>  | Beam Clamp M10 Rod Hanger | 20 | 11           | 50  | n/a |
| <b>TK12</b>   | Beam Clamp M12 rod Hanger | 26 | 13           | 50  | n/a |



## ANCHORING



### Strike™ Anchor Tie-Wire Ceiling Hanger

Carbon Steel Zinc Clear

ZINC INTERNAL



| Part No. | Description                    | mm  | mm | mm  | qty | qty  |
|----------|--------------------------------|-----|----|-----|-----|------|
| STTW05   | 5.0 mm Tie Wire Strike™ Anchor | 5   | 30 | 5.5 | 100 | 1000 |
| STTW65   | 6.5 mm Tie Wire Strike™ Anchor | 6.5 | 25 | 7   | 100 | 1000 |

\* Also referenced on Page 35



### Strike™ Anchor Mushroom Head

Carbon Steel Mechanically Galvanised

Stainless Steel 316 A4

GAL EXTERNAL 316 SS EXTERNAL



| Part No.   | Part No.    | Description | mm  | mm | qty | qty  |
|------------|-------------|-------------|-----|----|-----|------|
| STMH05025G | STMH05025SS | 5 x 25mm    | 5   | 3  | 100 | 2500 |
| STMH05032G | STMH05032SS | 5 x 32mm    |     | 10 | 100 | 2500 |
| STMH05038G | STMH05038SS | 5 x 38mm    |     | 6  | 100 | 2500 |
| STMH05050G | STMH05050SS | 5 x 50mm    |     | 19 | 100 | 1600 |
| STMH65025G |             | 6.5 x 25mm  | 6.5 | 3  | 100 | 2000 |
| STMH65038G | STMH65038SS | 6.5 x 38mm  |     | 6  | 100 | 1600 |
| STMH65050G | STMH65050SS | 6.5 x 50mm  |     | 19 | 100 | 1000 |
| STMH65063G |             | 6.5 x 63mm  |     | 32 | 100 | 1000 |
| STMH65075G | STMH65075SS | 6.5 x 75mm  |     | 44 | 100 | 1000 |
| STMH65100G |             | 6.5 x 100mm |     | 68 | 100 | 600  |
| STMH10075G |             | 10 x 75mm   | 10  | 32 | 25  | 400  |
| STMH10100G |             | 10 x 100mm  |     | 57 | 25  | 300  |
| STMH10125G |             | 10 x 125mm  |     | 82 | 25  | 250  |



### Strike™ Anchor Formwork Head

Carbon Steel Mechanically Galvanised

**NEW**

GAL EXTERNAL



| Part No.   | Description | mm  | mm | qty | qty  |
|------------|-------------|-----|----|-----|------|
| STFW05050G | 5 x 50mm    | 5   | 18 | 100 | 1000 |
| STFW05063G | 5 x 63mm    |     | 31 | 100 | 1000 |
| STFW65063G | 6.5 x 63mm  | 6.5 | 31 | 100 | 1000 |
| STFW65100G | 6.5 x 100mm |     | 68 | 100 | 600  |



**ANCHORING**



# Strike™ Anchor Countersunk

■ Carbon Steel Mechanically Galvanised

**GAL** EXTERNAL



| Part No.   | Description | mm  | mm | qty | qty  |
|------------|-------------|-----|----|-----|------|
| STCS05065G | 5 x 65mm    | 5   | 33 | 100 | 1000 |
| STCS05075G | 5 x 75mm    |     | 43 | 100 | 1000 |
| STCS05100G | 5 x 100mm   |     | 68 | 100 | 1000 |
| STCS65038G | 6.5 x 38mm  | 6.5 | 6  | 100 | 1600 |
| STCS65050G | 6.5 x 50mm  |     | 18 | 100 | 1000 |
| STCS65065G | 6.5 x 65mm  |     | 33 | 100 | 1000 |
| STCS65075G | 6.5 x 75mm  |     | 43 | 100 | 1000 |
| STCS65100G | 6.5 x 100mm |     | 68 | 100 | 600  |

## SYMPAFIX® CA-PLUS

SA TS101:2015 CODE COMPLIANT

- SA TS101:2015 code compliant
- Approved for cracked concrete
- European Technical Assessment (ETA)
- Fire rated performance
- All metal construction
- Tamper resistant head
- Clean, low profile aesthetic appearance

Expansion pin

Hammer impact point

ICCONS® Sympafix CA-Plus is an all metal wedge style anchor that sets by hammer impact, thus sliding the pin down the stem creating an expansive force against the wall of the hole. Ideal for mechanical trades using suspending strap, various hanger systems, through fixings, fire collar mountings etc.

ALL-METAL

# SYMPAFIX® CA-Plus Splice Anchor Metal Wedge Anchor

□ Carbon Steel Zinc Clear

NEW



**ZINC** INTERNAL



| Part No.            | Description | mm | mm | qty | qty  |
|---------------------|-------------|----|----|-----|------|
| SPZ0635-A (CA-Plus) | 6 x 35mm    | 6  | 3  | 200 | 1600 |
| SPZ0665-A (CA-Plus) | 6 x 65mm    |    | 33 | 100 | 1000 |





### Nylon Nailin Anchor Countersunk

■ Carbon Steel Zinc Yellow Pin

ZINC INTERNAL

| Part No. | Description | mm  | mm  | qty | qty  |
|----------|-------------|-----|-----|-----|------|
| NNC05025 | 5 x 25mm    | 5   | 6.5 | 100 | 1000 |
| NNC65025 | 6.5 x 25mm  | 6.5 | 6.5 | 100 | 1000 |
| NNC65038 | 6.5 x 38mm  |     | 19  | 100 | 1000 |
| NNC65050 | 6.5 x 50mm  |     | 32  | 100 | 1000 |
| NNC65075 | 6.5 x 75mm  |     | 50  | 100 | 1000 |



### Nylon Nailin Anchor Mushroom Head

■ Carbon Steel Zinc Yellow Pin

■ Stainless Steel 304 A2 Pin

ZINC INTERNAL 304 SS EXTERNAL

| Part No. | Part No.   | Description | mm  | mm  | qty | qty  |
|----------|------------|-------------|-----|-----|-----|------|
| NNM05025 | NNM05025SS | 5 x 25mm    | 5   | 6.5 | 100 | 1000 |
| NNM65025 | NNM65025SS | 6.5 x 25mm  | 6.5 | 6.5 | 100 | 1000 |
| NNM65038 |            | 6.5 x 38mm  |     | 19  | 100 | 1000 |
| NNM65050 |            | 6.5 x 50mm  |     | 32  | 100 | 1000 |
| NNM65075 |            | 6.5 x 75mm  |     | 50  | 100 | 1000 |



### Nylon Nailin Anchor Round Head

■ Carbon Steel Zinc Yellow Pin

■ Stainless Steel 304 A2 Pin

ZINC INTERNAL 304 SS EXTERNAL

| Part No. | Part No.   | Description | mm  | mm  | qty | qty  |
|----------|------------|-------------|-----|-----|-----|------|
| NNR05025 | NNR05025SS | 5 x 25mm    | 5   | 6.5 | 100 | 1000 |
| NNR05040 |            | 5 x 40mm    |     | 19  | 100 | 1000 |
| NNR65025 | NNR65025SS | 6.5 x 25mm  | 6.5 | 6.5 | 100 | 1000 |
| NNR65038 | NNR65038SS | 6.5 x 38mm  |     | 19  | 100 | 1000 |
| NNR65050 |            | 6.5 x 50mm  |     | 32  | 100 | 1000 |



## ANCHORING



## Metal Drive Anchor

Body - ZAMAC Alloy, Pin - Carbon Steel Zinc Clear

ZINC INTERNAL



| Part No. | Description | mm  | mm  | qty | qty |
|----------|-------------|-----|-----|-----|-----|
| MP05022  | 5 x 22mm    | 5   | 6.5 | 100 | 500 |
| MP65020  | 6.5 x 20mm  | 6.5 | 6.5 | 100 | 500 |
| MP65025  | 6.5 x 25mm  |     | 10  | 100 | 500 |
| MP65032  | 6.5 x 32mm  |     | 17  | 100 | 500 |
| MP65038  | 6.5 x 38mm  |     | 23  | 100 | 500 |
| MP65050  | 6.5 x 50mm  |     | 35  | 100 | 500 |

Not recommended for overhead use



## Metal Drive Hammer Screw

Body - ZAMAC Alloy, Pin - Carbon Steel Zinc Clear

Threaded square drive screw allows for easy removability if required

ZINC INTERNAL



| Part No.  | Description | mm  | head     | mm | qty | qty |
|-----------|-------------|-----|----------|----|-----|-----|
| MPHS65032 | 6.5 x 32mm  | 6.5 | sq / no2 | 17 | 100 | 500 |
| MPHS65038 | 6.5 x 38mm  | 6.5 | sq / no2 | 23 | 100 | 500 |



## Nylon Grey Plug



| Part No. | Description | mm | mm        | qty | qty  |
|----------|-------------|----|-----------|-----|------|
| NGP0525  | 5 x 25mm    | 5  | 3.0 - 3.5 | 300 | 3000 |
| NGP0630  | 6 x 30mm    | 6  | 3.5 - 4.0 | 200 | 2000 |
| NGP0738  | 7 x 38mm    | 7  | 4.5 - 5.5 | 100 | 1000 |
| NGP0840  | 8 x 40mm    | 8  | 5.0 - 6.0 | 100 | 1000 |
| NGP1050  | 10 x 50mm   | 10 | 6.0 - 7.5 | 50  | 500  |
| NGP1260  | 12 x 60mm   | 12 | 7.5 - 8.0 | 25  | 250  |

Refer page 205 for screw gauge conversion chart



**friulsider**

# NAUTILUS COATING

## Characteristics

- ▶ Corrosion resistance in Salt Spray: 1000 hours (red rust appearance)
- ▶ Thin (10µ): no interference on the threads
- ▶ Environmentally friendly: RoHS compliant and Chromium VI free
- ▶ Resistant to high temperatures

## Certifications:

- ▶ Salt Spray Test NSS according to UNI EN ISO 9227

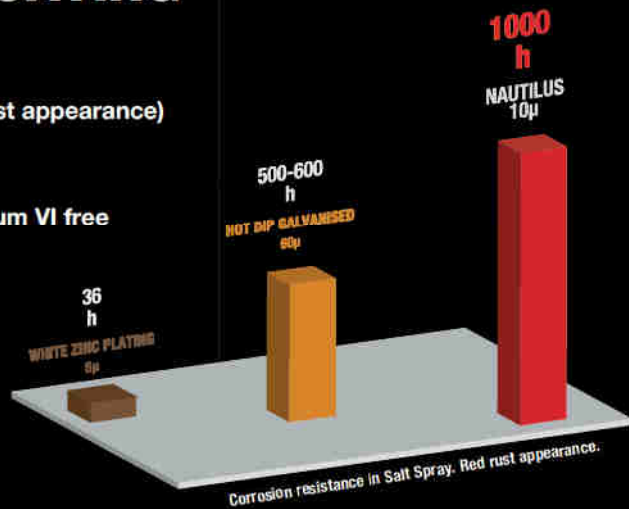

For products with the nautilus coating look for this  Logo



## friulsider TPP Hammer Screw

Carbon Steel Zinc Clear - Removable Screw

Stainless Steel 316 A2 - Removable Screw



ZINC INTERNAL  304 SS EXTERNAL



| Part No.                          | Part No.                            | Description | mm | mm | mm | Drive | Pin / mm | qty | qty  |
|-----------------------------------|-------------------------------------|-------------|----|----|----|-------|----------|-----|------|
| <b>FTPP05030</b><br>(62700b05030) |                                     | 5 x 30mm    | 5  | 25 | 5  | Pozi  | 3.4      | 300 | 3000 |
| <b>FTPP05050</b><br>(62700b05050) |                                     | 5 x 50mm    |    |    | 25 | Pozi  |          | 200 | 2000 |
| <b>FTPP06035</b><br>(62700b06035) |                                     | 6 x 35mm    | 6  | 30 | 5  | Pozi  | 3.8      | 200 | 2000 |
|                                   | <b>FTPP06040SS</b><br>(62701x06040) | 6 x 40mm    |    |    | 10 | Pozi  |          | 200 | 2000 |
| <b>FTPP06050</b><br>(62700b06050) | <b>FTPP06050SS</b><br>(62701x06050) | 6 x 50mm    |    |    | 20 | Pozi  |          | 100 | 1000 |
| <b>FTPP06060</b><br>(62700b06060) |                                     | 6 x 60mm    |    |    | 30 | Pozi  |          | 100 | 1000 |
| <b>FTPP08040</b><br>(62700b08040) |                                     | 8 x 40mm    | 8  | 35 | 5  | Pozi  | 4.8      | 200 | 2000 |
| <b>FTPP08060</b><br>(62700b08060) |                                     | 8 x 60mm    |    |    | 20 | Pozi  |          | 150 | 1500 |
| <b>FTPP08080</b><br>(62700b08080) | <b>FTPP08080SS</b><br>(62701x08080) | 8 x 80mm    |    |    | 40 | Pozi  |          | 150 | 1500 |
| <b>FTPP08100</b><br>(62700b08100) |                                     | 8 x 100mm   |    |    | 60 | Pozi  |          | 100 | 1000 |
| <b>FTPP08120</b><br>(62700b08120) |                                     | 8 x 120mm   |    |    | 80 | Pozi  |          | 100 | 1000 |





# ANCHORING



## friulsider FM-XP® Universal Nylon Plug



| Part No.                            | Description | mm | mm | mm  | qty | qty  |
|-------------------------------------|-------------|----|----|-----|-----|------|
| <b>FMXP06033</b><br>(66000u06033i6) | 6 x 33mm    | 6  | 33 | 4.5 | 200 | 2000 |
| <b>FMXP08052</b><br>(66000u08052i6) | 8 x 52mm    | 8  | 52 | 5   | 100 | 1000 |
| <b>FMXP10065</b><br>(66000u10065i6) | 10 x 65mm   | 10 | 65 | 6   | 50  | 500  |

Refer page 205 for screw gauge conversion chart



## friulsider TU Nylon Plug



| Part No.                           | Description | mm | mm | mm      | qty | qty  |
|------------------------------------|-------------|----|----|---------|-----|------|
| <b>FTU05025</b><br>(60101u05025i6) | 5 x 25mm    | 5  | 25 | 2.6 - 4 | 100 | 1000 |
| <b>FTU06030</b><br>(60101u06030i6) | 6 x 30mm    | 6  | 30 | 4.5     | 100 | 1000 |
| <b>FTU07035</b><br>(60101u07035i6) | 7 x 35mm    | 7  | 35 | 4.5 - 5 | 150 | 1500 |
| <b>FTU08040</b><br>(60101u08040i6) | 8 x 40mm    | 8  | 40 | 5       | 100 | 1000 |
| <b>FTU10050</b><br>(60101u10050i6) | 10 x 50mm   | 10 | 50 | 6 - 8   | 50  | 500  |
| <b>FTU12060</b><br>(60101u12060i6) | 12 x 60mm   | 12 | 60 | 8 - 10  | 25  | 250  |
| <b>FTU14080</b><br>(60101u14080i6) | 14 x 80mm   | 14 | 80 | 10 - 12 | 20  | 200  |
| <b>FTU16080</b><br>(60101u16080i6) | 16 x 80mm   | 16 | 80 | 12 - 14 | 15  | 150  |

Refer page 205 for screw gauge conversion chart



## friulsider TUP Nylon Through Anchor



| Part No.                            | Description | mm | mm | mm | mm  | qty | qty  |
|-------------------------------------|-------------|----|----|----|-----|-----|------|
| <b>FTUP06060</b><br>(60300u06060i6) | 6 x 60mm    | 6  | 30 | 30 | 4   | 100 | 1000 |
| <b>FTUP08060</b><br>(60300u08060i6) | 8 x 60mm    | 8  | 40 | 20 | 5.5 | 100 | 1000 |

Refer page 205 for screw gauge conversion chart



## friulsider TUP3 Nylon Through Anchor



| Part No.                             | Description | mm | mm  | mm      | qty | qty  |
|--------------------------------------|-------------|----|-----|---------|-----|------|
| <b>FTUP308080</b><br>(64200u08080i6) | 8 x 80mm    | 8  | 80  | 5.5 - 6 | 100 | 1000 |
| <b>FTUP310100</b><br>(64200u10100i6) | 10 x 100mm  | 10 | 100 | 7       | 100 | 1000 |

Refer page 205 for screw gauge conversion chart



# The Absolute Plug.



# X1

e v o

100% functioning with all screws, even metric threaded screws.

Dynamic Geometry

Extra thin collapsible countersunk rim



Endless Base Materials, Endless applications



Solid base material



Hollow base material



Plasterboard base material



## **friulsider X1 evo** The Absolute Plug

| Part No.                           | Description         |    |    |         |        |     |      |
|------------------------------------|---------------------|----|----|---------|--------|-----|------|
|                                    |                     | mm | mm | mm      | metric | qty | qty  |
| <b>FMX1P05025</b><br>(60070005025) | 5 x 25mm Plug only  | 5  | 25 | 3.5 - 4 | n/a    | 100 | 3200 |
| <b>FMX1P06030</b><br>(60070006030) | 6 x 30mm Plug only  | 6  | 30 | 4.5     | M4     | 100 | 3200 |
| <b>FMX1P08040</b><br>(60070008040) | 8 x 40mm Plug only  | 8  | 40 | 5 - 6   | M5     | 100 | 1600 |
| <b>FMX1P10050</b><br>(60070010050) | 10 x 50mm Plug only | 10 | 50 | 6       | M6     | 50  | 800  |
| <b>FMX1P12060</b><br>(60070012060) | 12 x 60mm Plug only | 12 | 60 | 8       | M8     | 25  | 400  |
| <b>FMX1P14070</b><br>(60070014070) | 14 x 70mm Plug only | 14 | 70 | 10      | M10    | 20  | 320  |

Refer page 205 for screw gauge conversion chart





**ANCHORING**



**friulsider X1 evo w/ Countersunk Screw**

☐ Carbon Steel Zinc Clear Countersunk Screw



| Part No.                            | Description  | mm | mm | mm      | metric |        | qty | qty  |
|-------------------------------------|--|----|----|---------|--------|--------|-----|------|
| <b>FX1PC05025</b><br>(60071b05025)  | 5 x 25mm with Countersunk Screw                      | 5  | 25 | 3.5 - 4 | 30     | Pozi 2 | 100 | 3200 |
| <b>FX1PC06030</b><br>(60071b06030)  | 6 x 30mm with Countersunk Screw                      | 6  | 30 | 4.5     | 40     | Pozi 2 | 100 | 1600 |
| <b>FX1PC06030B</b><br>(60071b06030) | 6 x 30mm with Countersunk Screw Bulk Bucket (200pce) | 6  | 30 | 4.5     | 40     | Pozi 2 | 1   | 1    |
| <b>FX1PC08040</b><br>(60071b08040)  | 8 x 40mm with Countersunk Screw                      | 8  | 40 | 5 - 6   | 50     | Pozi 2 | 50  | 800  |
| <b>FX1PC08040B</b><br>(60071b08040) | 8 x 40mm with Countersunk Screw Bulk Bucket (100pce) | 8  | 40 | 5 - 6   | 50     | Pozi 2 | 1   | 1    |
| <b>FX1PC10050</b><br>(60071b10050)  | 10 x 50mm with Countersunk Screw                     | 10 | 50 | 6       | 60     | Pozi 3 | 25  | 400  |

Refer page 205 for screw gauge conversion chart



**friulsider X1 evo w/ Hex Head Screw**

☐ Carbon Steel Zinc Clear Hex Head Screw



| Part No.                           | Description                   | mm | mm | mm    | mm | Drive(mm) | qty | qty |
|------------------------------------|-------------------------------|----|----|-------|----|-----------|-----|-----|
| <b>FX1PH08040</b><br>(60073b08040) | 8 x 40mm with Hex Head Screw  | 8  | 40 | 5 - 6 | 50 | 10        | 100 | 600 |
| <b>FX1PH10050</b><br>(60073b10050) | 10 x 50mm with Hex Head Screw | 10 | 50 | 6     | 60 | 10        | 100 | 400 |
| <b>FX1PH12060</b><br>(60073b12060) | 12 x 60mm with Hex Head Screw | 12 | 60 | 8     | 70 | 13        | 50  | 200 |
| <b>FX1PH14070</b><br>(60073b14070) | 14 x 70mm with Hex Head Screw | 14 | 70 | 10    | 80 | 17        | 25  | 150 |

Refer page 205 for screw gauge conversion chart



**friulsider X1 evo w/ Pan Head Screw**

☐ Carbon Steel Zinc Clear Pan Head Screw



| Part No.                           | Description                       | mm | mm | mm      | mm | drive  | qty | qty  |
|------------------------------------|-----------------------------------|----|----|---------|----|--------|-----|------|
| <b>FX1PP05025</b><br>(60072b05025) | 5 x 25mm with Wide Pan Head Screw | 5  | 25 | 3.5 - 4 | 30 | Pozi 2 | 100 | 1600 |
| <b>FX1PP06030</b><br>(60072b06030) | 6 x 30mm with Wide Pan Head Screw | 6  | 30 | 4.5     | 40 | Pozi 2 | 100 | 1200 |
| <b>FX1PP08040</b><br>(60072b08040) | 8 x 40mm with Wide Pan Head Screw | 8  | 40 | 5 - 6   | 50 | Pozi 3 | 50  | 600  |

Refer page 205 for screw gauge conversion chart

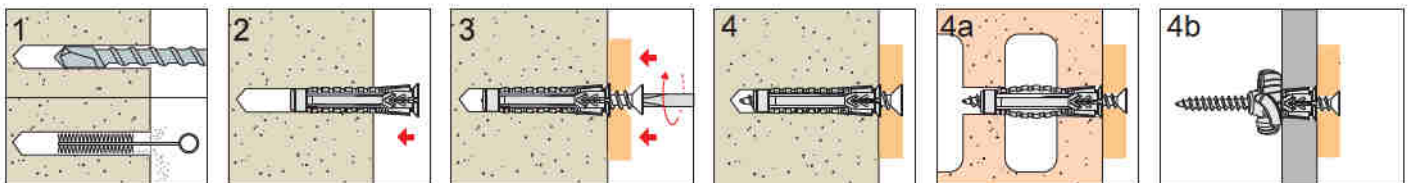





# FM-X5

## MULTI-EXPANSION LONG PLUG

- **NO WINGS:** *easy to install, adjust & even remove*
- **LOW TORQUE:** *can be blocked by hand*
- **Pre-assembled:** *ready to use, hammer in position*



**ULTRA FLEXIBLE**  
*High quality nylon*



**GREATER GRIP**  
*Innovative variable geometry  
multi-expansion*



**SCREW ALWAYS  
PRE-ASSEMBLED**  
*Ready to use.*

*Available in versions:*

- *White zinc plated,*
- *Nautilus,*
- *Stainless steel A4 70*



◊ NAUTILUS ◊

1000 h



**friulsider**



ANCHORING



**friulsider FM-X5** Nylon Frame Fixing

Carbon Steel Zinc Clear Hex Head Screw

Carbon Steel Galvanised Hex Head Screw

**NAUTILUS**  
+1000 h



ZINC INTERNAL GAL EXTERNAL

| Part No.                           | Part No.                            | Description | mm | mm | mm | mm                    | mm     | qty | qty  |
|------------------------------------|-------------------------------------|-------------|----|----|----|-----------------------|--------|-----|------|
| <b>FHMX510085</b><br>(64302b10085) | <b>FHMX510085G</b><br>(64302c10085) | 10 x 85mm   | 10 | 70 | 15 | Hex with internal T40 | 7 x 90 | 50  | 1000 |
| <b>FHMX510100</b><br>(64302b10100) | <b>FHMX510100G</b><br>(64302c10100) | 10 x 100mm  |    |    | 30 | Hex with internal T40 | 7 x 90 | 50  | 500  |
| <b>FHMX510115</b><br>(64302b10115) | <b>FHMX510115G</b><br>(64302c10115) | 10 x 115mm  |    |    | 45 | Hex with internal T40 | 7 x 90 | 50  | 500  |
| <b>FHMX510135</b><br>(64302b10135) | <b>FHMX510135G</b><br>(64302c10135) | 10 x 135mm  |    |    | 65 | Hex with internal T40 | 7 x 90 | 50  | 500  |
| <b>FHMX510160</b><br>(64302b10160) | <b>FHMX510160G</b><br>(64302c10160) | 10 x 160mm  |    |    | 90 | Hex with internal T40 | 7 x 90 | 50  | 500  |

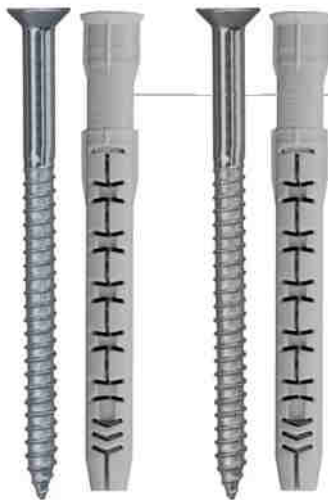

**friulsider FM-X5** Nylon Frame Fixing

Carbon Steel Zinc Clear Countersunk Screw

316SS Hex Head Screw



**NEW**  
Stainless Steel

ZINC INTERNAL 316 SS EXTERNAL

| Part No.                           | Part No.                             | Description | mm | mm | mm | mm      | mm     | qty | qty  |
|------------------------------------|--------------------------------------|-------------|----|----|----|---------|--------|-----|------|
| <b>FCMX510085</b><br>(64301b10085) | <b>FCMX510085SS</b><br>(64301010085) | 10 x 85mm   | 10 | 70 | 15 | T40 CSK | 7 x 90 | 50  | 1000 |
| <b>FCMX510100</b><br>(64301b10100) | <b>FCMX510100SS</b><br>(64301010100) | 10 x 100mm  |    |    | 30 | T40 CSK | 7 x 90 | 50  | 500  |
| <b>FCMX510115</b><br>(64301b10115) | <b>FCMX510115SS</b><br>(64301010115) | 10 x 115mm  |    |    | 45 | T40 CSK | 7 x 90 | 50  | 500  |
| <b>FCMX510135</b><br>(64301b10135) | <b>FCMX510135SS</b><br>(64301010135) | 10 x 135mm  |    |    | 65 | T40 CSK | 7 x 90 | 50  | 500  |
| <b>FCMX510160</b><br>(64301b10160) | <b>FCMX510160SS</b><br>(64301010160) | 10 x 160mm  |    |    | 90 | T40 CSK | 7 x 90 | 50  | 500  |





ANCHORING



◊ NAUTILUS ◊

+ 1000 h

**friulsider FM-X5 TOP**  
 TOP Performances comparable to metal anchors.

**TOP PLUG**  
Nylon PA 6.6 ultra resistant

**PULL-OUT VALUES DOUBLE**  
than FM-X5 in concrete

**TOP SCREW PREASSEMBLED**  
Asymmetrical thread and thicker diameter.

| Part No.                             | Part No.                              | Part No.                               | Description | mm | mm | mm | head                  | mm     | qty | qty  |
|--------------------------------------|---------------------------------------|--|-------------|----|----|----|-----------------------|--------|-----|------|
| <b>FMX5TH10085</b><br>(64405b1.0085) | <b>FMX5TH10085G</b><br>(64405c1.0085) | <b>FMX5TH10085SS</b><br>(6440501.0085) | 10 x 85mm   | 10 | 70 | 15 | Hex with internal T40 | 7 x 90 | 50  | 1000 |
| <b>FMX5TH10100</b><br>(64405b1.0100) | <b>FMX5TH10100G</b><br>(64405c1.0100) | <b>FMX5TH10100SS</b><br>(6440501.0100) | 10 x 100mm  |    |    | 30 | Hex with internal T40 | 7 x 90 | 50  | 500  |
| <b>FMX5TH10115</b><br>(64405b1.0115) | <b>FMX5TH10115G</b><br>(64405c1.0115) | <b>FMX5TH10115SS</b><br>(6440501.0115) | 10 x 115mm  |    |    | 45 | Hex with internal T40 | 7 x 90 | 50  | 500  |
| <b>FMX5TH10135</b><br>(64405b1.0135) | <b>FMX5TH10135G</b><br>(64405c1.0135) | <b>FMX5TH10135SS</b><br>(6440501.0135) | 10 x 135mm  |    |    | 65 | Hex with internal T40 | 7 x 90 | 50  | 500  |
| <b>FMX5TH10160</b><br>(64405b1.0160) | <b>FMX5TH10160G</b><br>(64405c1.0160) | <b>FCMX510160SS</b><br>(6440501.0160)  | 10 x 160mm  |    |    | 90 | Hex with internal T40 | 7 x 90 | 50  | 500  |



**friulsider FM-X5s** Reduced Embedment Nylon Frame Fixing

☐ Carbon Steel Zinc Clear Hex Head Screw

■ Carbon Steel Galvanised Hex Head Screw w/ flanged Plug **◊ NAUTILUS ◊**  
+ 1000 h

■ Carbon Steel Galvanised Hex Head Screw non flanged Plug **◊ NAUTILUS ◊**  
+ 1000 h

| Part No.                             | Part No.                              | Part No.                            | Description | mm | mm | mm | head                  | mm     | qty | qty |
|--------------------------------------|---------------------------------------|-------------------------------------|-------------|----|----|----|-----------------------|--------|-----|-----|
| <b>FMX5SH10060</b><br>(64404b1.0060) | <b>FMX5SH10060G</b><br>(64404c1.0060) | <b>FMX5SHNF10060G</b><br><b>NEW</b> | 10 x 60     | 10 | 55 | 10 | Hex with internal T40 | 7 x 65 | 50  | 500 |





ANCHORING



**friulsider FM-X5 SAFER**

Anti-Intrusion System

Carbon Steel Zinc Clear Hex Head Screw

316SS Hex Head Screw

**NEW**

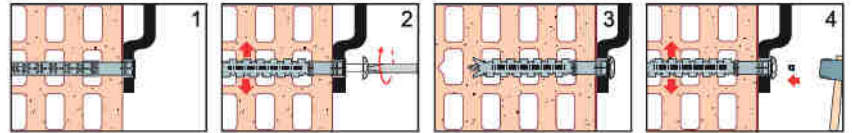

ZINC INTERNAL 316 SS EXTERNAL

| Part No.                       | Part No.                         | Description | mm | mm | mm | mm      | mm     | qty | qty  |
|--------------------------------|----------------------------------|-------------|----|----|----|---------|--------|-----|------|
| FCMX5SAF10085<br>(54301b10085) | FCMX5SAF10085SS<br>(54301010085) | 10 x 85mm   | 10 | 70 | 15 | T40 CSK | 7 x 90 | 50  | 1000 |

**SPRAY&AWAY**

**GENIUS SPRAY**

Professional high lubricating unblocking spray  
 Penetrates and immediately releases: nuts, bolts, chains, bearings, hinges, pulleys, conveyer belts, etc. It works even in the most difficult cases of seizure and oxidation. It leaves a durable and water-repellent protective film.

**NEW**

**friulsider G40 Genius Spray**  
 Professional Multi purpose spray

- Unblocking
- Penetrating
- Lubricant
- Protective film
- Water repellent
- Solvent
- Nozzle extension located in Cap



| Part No. | Description  | qty |
|----------|--|-----|
| FG4000   | 400ml Professional high lubricating unblocking spray | 12  |

also appears on Page 82



ANCHORING



**friulsider FM-ISO MAX** Insulation Nail

❑ **Fixing with steel nail for ETICS thermal insulation system**  
 Concrete, solid brick, honeycomb brick, cell like clay brick, lightweight honeycomb brick, hollow dense aggregate block, hollow light aggregate block, aerated concrete and solid stone.

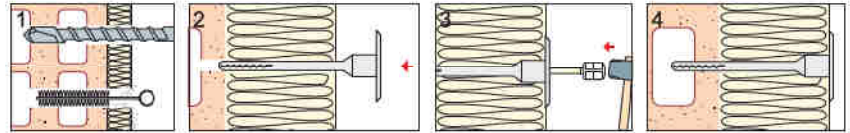

| Part No.                                 | Description | mm | mm      | mm | qty |
|--|-------------|----|---------|----|-----|
| <b>FM-ISOMAX08100</b><br>(6192500810000) | 8 x 100mm   | 8  | 25 - 45 | 60 | 200 |
| <b>FM-ISOMAX08120</b><br>(6192500812000) | 8 x 120mm   |    | 45 - 65 | 60 | 200 |
| <b>FM-ISOMAX08140</b><br>(6192500812000) | 8 x 140mm   |    | 65 - 85 | 60 | 200 |

Please refer to insulation manufacturer instructions for fastener suitability.



**friulsider FM-ISO METAL** Insulation Nail

❑ **Metallic insulation panel fixing**  
 Concrete, solid brick, aerated concrete and solid stone.

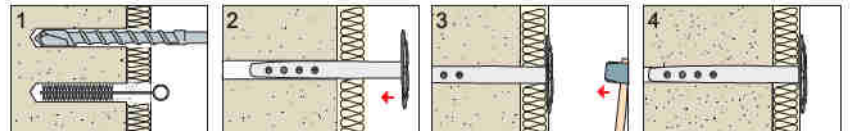

| Part No.                                   | Description | mm | mm      | mm | qty |
|--|-------------|----|---------|----|-----|
| <b>FM-ISOMETAL09060</b><br>(61933b0906000) | 8 x 60mm    | 8  | 20      | 40 | 250 |
| <b>FM-ISOMETAL09080</b><br>(61933b0908000) | 8 x 80mm    |    | 20 - 40 | 40 | 250 |
| <b>FM-ISOMETAL09110</b><br>(61933b0911000) | 8 x 110mm   |    | 50 - 70 | 40 | 250 |
| <b>FM-ISOMETAL09140</b><br>(61933b0914000) | 8 x 140mm   |    | 75 - 95 | 40 | 250 |

Please refer to insulation manufacturer instructions for fastener suitability.

**Nylon Insulation Washer**

For securing insulation board  
 Use with Class 3 bugle head or chipboard screws



| Part No.     | Description                                    | qty | qty  |
|--------------|--|-----|------|
| <b>PWY40</b> | 40mm OD, suits bugle head and chipboard screws | 100 | 1000 |





# FOX For Fastening to Foam Insulation Cladding

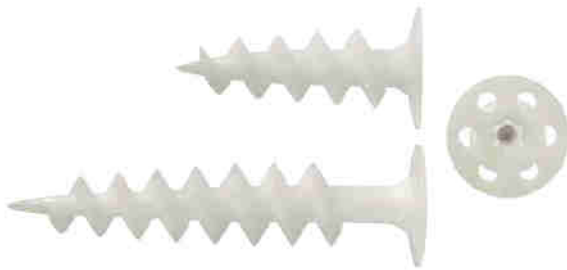

## friulside **FOX** Torx T40 Recess - Ø25

**NEW**

Suitable for fixing:

- Lighting
- Post boxes
- Signs
- Electrical applications



| Part No.                            | Description | Min. insertion of screw mm | Gauge | qty |
|-------------------------------------|-------------|----------------------------|-------|-----|
| <b>FOXIPT25050</b><br>(61951025050) | 25 x 50mm   | 30                         | 10g   | 50  |
| <b>FOXIPT25085</b><br>(61951025085) | 25 x 85mm   | 40                         | 10g   | 25  |

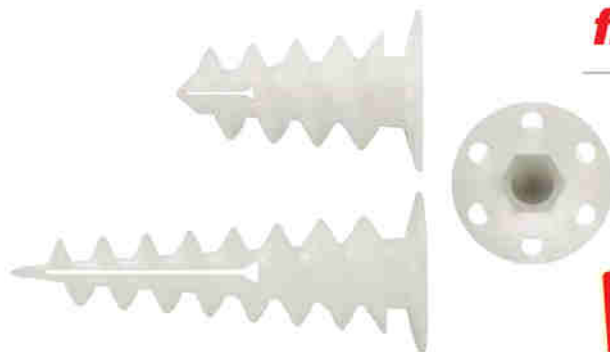

## friulside **FOX** Hex Recess - Ø33

**NEW**

Suitable for fixing:

- Drain pipe collars
- Heating/cooling applications
- Lighting
- Post boxes
- Signs
- Electrical applications



| Part No.                            | Description | Min. insertion of screw mm | Metric | Wood / mm | qty |
|-------------------------------------|-------------|----------------------------|--------|-----------|-----|
| <b>FOXIPH33050</b><br>(61951033050) | 33 x 50mm   | 50                         | M8     | 8         | 50  |
| <b>FOXIPH33085</b><br>(61951033085) | 33 x 85mm   | 50                         | M8     | 8         | 25  |

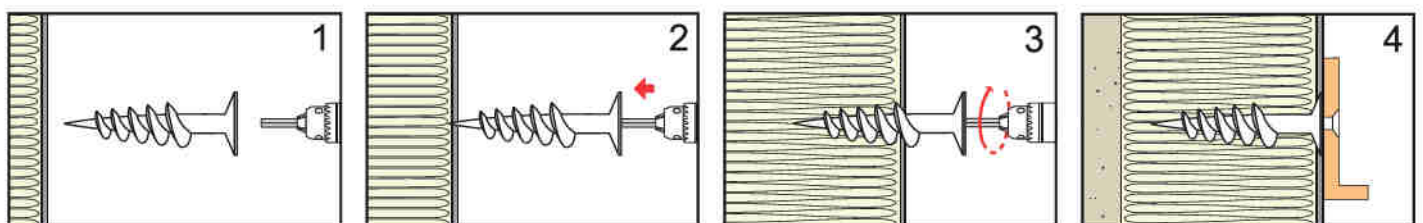





## ANCHORING



50 meter

50 meter

5 meter

## Plastic Spaghetti Roll 5.0mm & 5.5mm

| Part No. | Part No. | Description | Plug Colour | mm  | mm        | qty | qty |
|----------|----------|-------------|-------------|-----|-----------|-----|-----|
| PSG550   |          | 5.0mm x 50m |             | 5.5 | 3.0 - 3.5 | 1   | 10  |
|          | PSR5550  | 5.5mm x 50m |             | 6   | 3.5 - 4.0 | 1   | 10  |
|          | PSR5505S | 5.5mm x 5m  |             | 6   | 3.5 - 4.0 | 1   | 50  |

Refer page 205 for screw gauge conversion chart

## PVC Wall Plug 6mm



| Part No. | Description | Plug Colour | mm | mm      | qty  | No. Of Frames        |
|----------|-------------|-------------|----|---------|------|----------------------|
| PVCR25   | 6 x 25mm    |             | 6  | 8g /4mm | 1000 | 25 plugs x 40 frames |
| PVCR30   | 6 x 30mm    |             |    | 8g /4mm | 1000 | 25 plugs x 40 frames |
| PVCR38   | 6 x 38mm    |             |    | 8g /4mm | 1000 | 25 plugs x 40 frames |
| PVCR50   | 6 x 50mm    |             |    | 8g /4mm | 1000 | 25 plugs x 40 frames |

## PVC Wall Plug 7mm



| Part No. | Description | Plug Colour | mm | mm                    | qty  | No. Of Frames        |
|----------|-------------|-------------|----|-----------------------|------|----------------------|
| PVCG25   | 7 x 25mm    |             | 7  | 10g - 12g / 5 - 5.5mm | 1000 | 25 plugs x 40 frames |
| PVCG30   | 7 x 30mm    |             |    | 10g - 12g / 5 - 5.5mm | 1000 | 25 plugs x 40 frames |
| PVCG38   | 7 x 38mm    |             |    | 10g - 12g / 5 - 5.5mm | 500  | 25 plugs x 20 frames |
| PVCG50   | 7 x 50mm    |             |    | 10g - 12g / 5 - 5.5mm | 500  | 25 plugs x 20 frames |

## PVC Wall Plug 8mm

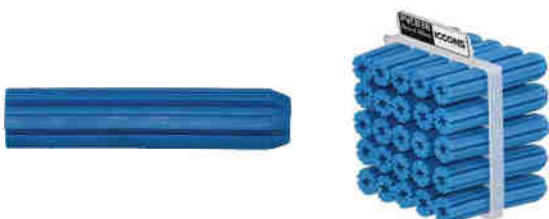

| Part No. | Description | Plug Colour | mm | mm            | qty  | No. Of Frames        |
|----------|-------------|-------------|----|---------------|------|----------------------|
| PVCB25   | 8 x 25mm    |             | 8  | 14g / 6 - 7mm | 1000 | 25 plugs x 40 frames |
| PVCB38   | 8 x 38mm    |             |    | 14g / 6 - 7mm | 500  | 25 plugs x 20 frames |
| PVCB50   | 8 x 50mm    |             |    | 14g / 6 - 7mm | 500  | 25 plugs x 20 frames |



# Toggle Strap Hollow Wall Anchor

Problem solving long reach hollow wall anchor

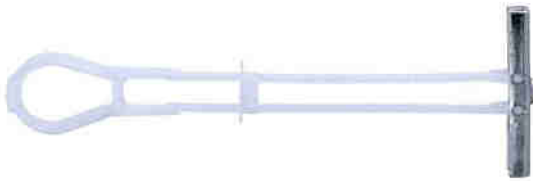

| Part No.      | Description           | mm | metric | mm         | qty | qty |
|---------------|-----------------------|----|--------|------------|-----|-----|
| <b>PTSM06</b> | M6 Hollow Wall Anchor | 13 | M6     | Up to 64mm | 50  | 300 |

# Spring Toggles

Round Head - Zinc Clear

Cup Hook - Zinc Clear



ZINC INTERNAL ZINC INTERNAL



| Part No.        | Part No.          | Description   | mm | mm | qty | qty |
|-----------------|-------------------|---------------|----|----|-----|-----|
| <b>STR18-2</b>  |                   | 1/8" X 50mm   | 10 | 30 | 50  | 150 |
| <b>STR18-3</b>  |                   | 1/8" X 75mm   |    | 50 | 100 | 300 |
| <b>STR316-2</b> |                   | 3/16" X 50mm  | 13 | 25 | 50  | 150 |
| <b>STR316-3</b> |                   | 3/16" X 75mm  |    | 48 | 50  | 150 |
|                 | <b>STRCH316-3</b> | 3/16" x 75mm  |    | 50 | 50  | 150 |
| <b>STR316-4</b> |                   | 3/16" X 100mm |    | 74 | 50  | 150 |

# Toggle Plug

### Duo-Function

Light duty duo-function nylon anchor for use in solid masonry or to function as a toggle anchor in hollow materials

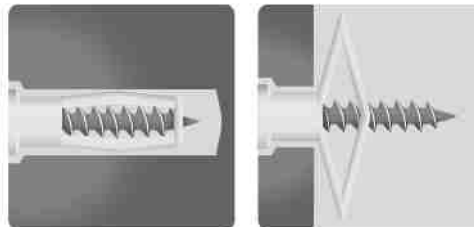

| Part No.     | Description              | mm | mm      | mm                  | qty | qty  |
|--------------|--------------------------|----|---------|---------------------|-----|------|
| <b>PTP10</b> | 10mm Plastic Toggle Plug | 8  | 10 - 13 | 3.5 (6g) - 4.2 (8g) | 100 | 1000 |
| <b>PTP13</b> | 13mm Plastic Toggle Plug | 8  | 13 - 16 | 3.5 (6g) - 4.2 (8g) | 100 | 1000 |
| <b>PTP16</b> | 16mm Plastic Toggle Plug | 8  | 16 - 20 | 3.5 (6g) - 4.2 (8g) | 100 | 1000 |



IDEAL IN PLASTERBOARD, WOOD & MASONRY



**DOG-BITE**

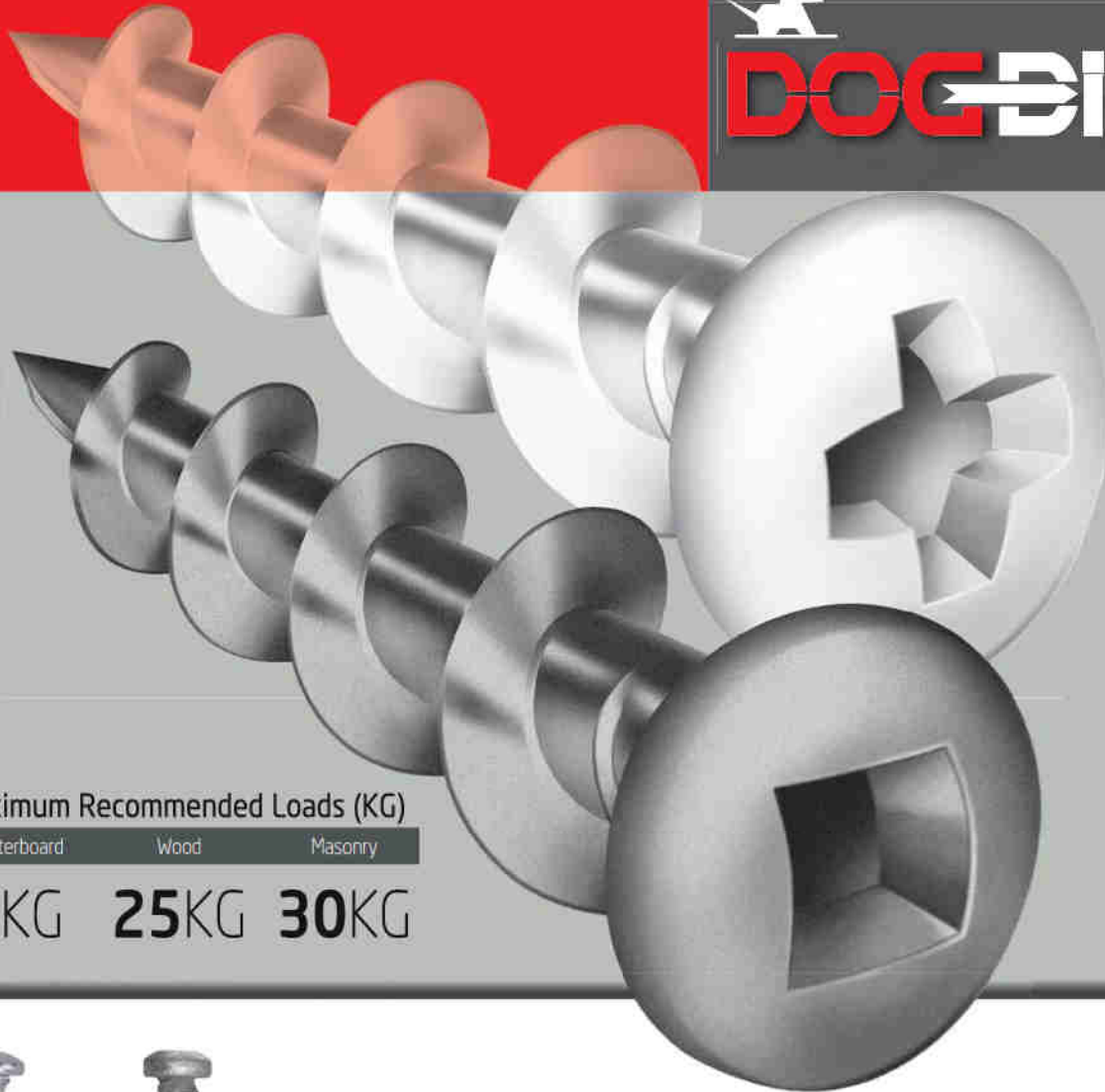

Maximum Recommended Loads (KG)

Plasterboard    Wood    Masonry

**3KG    25KG    30KG**

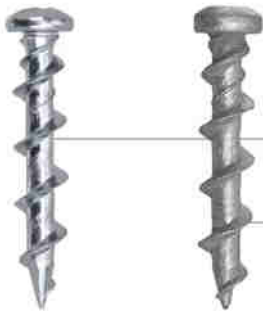

**Dog-Bites™**

Zinc Clear

Carbon Steel Mechanically Galvanised

**NEW**



ZINC

INTERNAL

GAL

EXTERNAL



Drive Type



|               | Part No.   | Part No.    | Description   | mm | Drive  | mm | qty | qty |
|---------------|------------|-------------|---------------|----|--------|----|-----|-----|
| Phillips Head | DBPH32-100 | DBH32G-100  | 32mm Pan head | 5  | No2 PH | 20 | 100 | TBA |
|               | DBPH32-500 | DBPH32-500  | 32mm Pan head |    | No2 PH |    | 500 | TBA |
|               | DBPH50-100 | DBPH50G-100 | 50mm Pan head | 5  | No2 PH | 20 | 100 | TBA |
|               | DBPH50-500 | DBPH50G-500 | 50mm Pan head |    | No2 PH |    | 500 | TBA |
| Square Drive  | DPSQ32-100 | DBSQ32G-100 | 32mm Pan head | 5  | No2 Sq | 20 | 100 | TBA |
|               | DPSQ32-500 | DBSQ32G-500 | 32mm Pan head |    | No2 Sq |    | 500 | TBA |
|               | DBSQ50-100 | DBSQ50G-100 | 50mm Pan head | 5  | No2 Sq | 20 | 100 | TBA |
|               | DBSQ50-500 | DBSQ50G-500 | 50mm Pan head |    | No2 Sq |    | 500 | TBA |

Note: When fixing to aerated concrete (Hebel) it is recommended to pre-drill a 3mm hole, for plasterboard and timber based materials no need to pre-drill hole





## ANCHORING

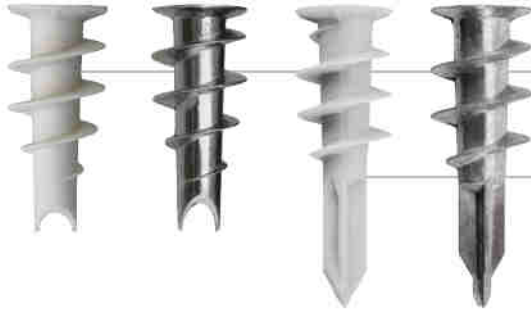

### Plaster-Bites®

Fish Mouth - Metal or Nylon Plaster-Bites®

Drill Point Metal or Nylon Plaster-Bites®

| Part No. | Part No. | Part No.  | Part No.  | Description                                | mm                  | qty | qty  |
|----------|----------|-----------|-----------|--|---------------------|-----|------|
| PBNYLON  | PBMETAL  | PBNYLONDP | PBMETALDP | Self drilling wall anchor for plasterboard | 3.5 (6g) - 4.2 (8g) | 100 | 1000 |

### Plaster-Bites® With Screw

Drill Point Nylon Plaster-Bites®

**NEW**



| Part No.     | Description  | mm                      | qty | qty  |
|--------------|--|-------------------------|-----|------|
| PBNYLONDP-WS | Self drilling wall anchor for plasterboard with Pan head screw | Ph2 3.5 (6g) - 4.2 (8g) | 100 | 1000 |

### Grip Nut

Multi-purpose problem solving EPDM Rivet style fixing  
Perfect for use in tiles /sanitary fittings etc  
Acoustical fixing (sound dampening)



WITHOUT SCREW

WITH SCREW

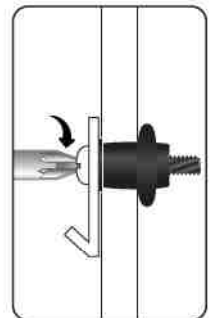
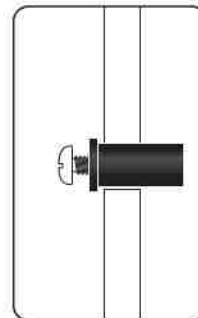
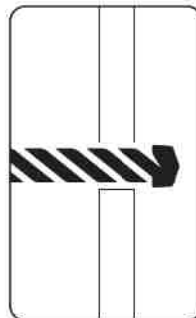

| Part No. | Part No. | Description | mm | mm | qty | qty  |
|----------|----------|-------------|----|----|-----|------|
| GNM410   |          | M4 x 10mm   | 8  | 4  | 200 | 5000 |
| GNM515   |          | M5 x 15mm   | 10 | 5  | 200 | 5000 |
| GNM525   |          | M5 x 25mm   |    | 16 | 100 | 1600 |
| GNM540   | GNM540WS | M5 x 40mm   |    | 30 | 50  | 800  |

\*M4 & M5 machine threaded Pan Head (Phillips #2) screws available on request.



**ANCHORING**

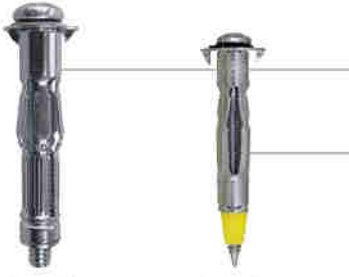

# Hollow Wall Anchor

Zinc Clear for use with setting tool HA-STHD.

Zinc Clear Drive In.

| Part No. | Part No. | Description                 | mm | mm      | qty | qty  |
|----------|----------|-----------------------------|----|---------|-----|------|
| HA4XS    |          | 8mm x 20mm (with M4 screw)  | 8  | 0-5     | 100 | 500  |
| HA4S     | HA4SD    | 8mm x 32mm (with M4 screw)  |    | 5 - 10  | 100 | 500  |
| HA4SL    |          | 8mm x 46mm (with M4 screw)  |    | 10 - 18 | 100 | 1000 |
| HA4L     |          | 8mm x 46mm (with M4 screw)  |    | 18 - 24 | 100 | 500  |
| HA6S     |          | 10mm x 52mm (with M6 screw) | 10 | 10 - 21 | 50  | 250  |
| HA8S     |          | 11mm x 52mm (with M8 screw) | 11 | 10 - 21 | 50  | 250  |



## Hollow Wall Anchor Setting Tool

### The Original Optee

- Controlled expansion
- No crushing of the wall
- Optimal fit

**NEW**



| Part No. | Description             | qty | qty |
|----------|-------------------------|-----|-----|
| HA-STHD  | Heavy Duty Setting Tool | 1   | 20  |

### FEATURES

1. Material - Brushed aluminium.
2. Ergonomic handle - Allows quick and easy installation, smooth and effortless.
3. Adjustable expansion - suitable for all anchor lengths.
4. Soft Touch Pad - Doesn't damage the wall during use.
5. Handle lock function - For safe and easy storage.
6. Suitable for the expansion of all hollow wall anchors 1/8" to 3/16".



**The Only one in Australia!**





## Packing Shims - Boxes & Tubs

For Packing around Windows & Doors

| Part No. | Part No.     | Description                      | Colour | qty | qty  |
|----------|--------------|----------------------------------|--------|-----|------|
| PKS01575 |              | 1.5mm x 75mm White Packer - BOX  |        | 100 | 2400 |
|          | PKS01575-TUB | 1.5mm x 75mm White Packer - TUB  |        | 800 | 3200 |
| PKS03275 |              | 3.2mm x 75mm Blue Packer - BOX   |        | 100 | 1200 |
|          | PKS03275-TUB | 3.2mm x 75mm Blue Packer - TUB   |        | 500 | 2000 |
| PKS05075 |              | 5.0mm x 75mm Red Packer - BOX    |        | 100 | 800  |
|          | PKS05075-TUB | 5.0mm x 75mm Red Packer - TUB    |        | 400 | 1600 |
| PKS06475 |              | 6.4mm x 75mm Green Packer - BOX  |        | 100 | 800  |
|          | PKS06475-TUB | 6.4mm x 75mm Green Packer - TUB  |        | 300 | 1200 |
| PKS10075 |              | 10.0mm x 75mm Black Packer - BOX |        | 100 | 600  |
|          | PKS10075-TUB | 10.0mm x 75mm Black Packer - TUB |        | 200 | 800  |



## Packing Shims - Mixed Tub

For Packing around Windows & Doors

| Part No.   | Description                      | Colour | qty               | qty                   |
|------------|----------------------------------|--------|-------------------|-----------------------|
| PKSMIX-TUB | 1.5mm x 75mm White Packer - BOX  |        | 1 Tub<br>(400pce) | 4 x Tubs<br>(1600pce) |
|            | 3.2mm x 75mm Blue Packer - BOX   |        |                   |                       |
|            | 5.0mm x 75mm Red Packer - BOX    |        |                   |                       |
|            | 6.4mm x 75mm Green Packer - BOX  |        |                   |                       |
|            | 10.0mm x 75mm Black Packer - BOX |        |                   |                       |



EVERY TOOL BOX NEEDS A WINBAG!

## Winbag Inflatable Packing Device

- Save Time
- No More Shims
- Max Load 100KGS / winbag
- For joints 2mm to 50mm
- Can be used again and again
- Leaves joint empty ready for sealing
- Easy & Effective
- Adjusting and positioning heavy doors
- Window frames installation
- Levelling appliances
- Soft air cushion doesn't leave scratches or marks & protects the frame

| Part No. | Description                                       | Joint Width    | Load Capacity | qty |
|----------|---|----------------|---------------|-----|
| PKSWNBAG | WINBAG - Inflatable and Adjustable Packing Device | mm<br>2 - 50mm | kg<br>100 kg  | 1   |





# Knurled Shank Masonry Nail

Zinc Clear

ZINC



| Part No. | Description | mm | mm  | qty | qty  |
|----------|-------------|----|-----|-----|------|
| KMN25    | 3.7 x 25mm  | 25 | 3.7 | 100 | 2000 |
| KMN40    | 3.7 x 40mm  | 40 | 3.7 | 100 | 1000 |
| KMN50    | 3.7 x 50mm  | 50 | 3.7 | 100 | 1000 |
| KMN65    | 3.7 x 65mm  | 65 | 3.7 | 100 | 1000 |
| KMN75    | 3.7 x 75mm  | 75 | 3.7 | 100 | 1000 |

\* Also referenced on Page 100



# Mickey Pins

Zinc Clear

ZINC



| Part No. | Description                                    | mm | mm  | qty | qty  |
|----------|--|----|-----|-----|------|
| MPW20    | Washed Mickey Pin hand drive nail - 20 x 2.5mm | 20 | 2.5 | 500 | 5000 |
| MPW25    | Washed Mickey Pin hand drive nail - 25 x 2.5mm | 25 | 2.5 | 500 | 5000 |
| MPW30    | Washed Mickey Pin hand drive nail - 30 x 2.5mm | 30 | 2.5 | 500 | 5000 |
| MPW40    | Washed Mickey Pin hand drive nail - 40 x 2.5mm | 40 | 2.5 | 500 | 4000 |
| MPW50    | Washed Mickey Pin hand drive nail - 50 x 2.5mm | 50 | 2.5 | 500 | 4000 |

\* Also referenced on Page 101